

Topvex SC20-L-EL4,2-B ODK

O-SC20-L-N-ePM1/60-CE-B-C1-EL4,2-ePM10/60-AC

Item Number: 281806



Side-connected model of compact air handling units for outdoor applications

Topvex SC family is a side connected model that includes five sizes. The air handling units are equipped with highly efficient counterflow heat exchanger with capacity well over 80%. The airflow range covers volume flow from 350 up to 6900m³/h. The user-friendly Access Control system is the common platform for all Topvex models. The standardised design guarantees a fully factory tested unit, available with short delivery time.

The units also offer low SFP Values and provides more options for outdoor connectivity. An external roof to be mounted on site will be delivered together with the unit.



Counter-flow heat exchanger above 80% dry efficiency (EN308)

- No mixing of extract and supply air
- Automatic summer operating
- Cool recovering
- 100% By-pass of heat exchanger
- Section defrosting to ensure highest efficiency during toughest conditions

Low energy use

- Low SFPv
- Energy efficient plug fans with EC motors (speed controlled)

Water or electrical reheaters

- Constant air volume control (CAV) is standard
- Variable air volume control (VAV) is available as an accessory

Large inspection doors for easy maintenance

- All main components are easy to remove

Manufactured in ZM310 plated sheet metal with corrosion class C5

Factory tested

Systemair Access control system

All models are equipped with Systemair Access control system with a vast range of energy optimizing functionality. Together with the intuitive user interface in the Access NaviPad control panel, enables an easy and flexible control solution.

- External control cabinet for easy access and installation
- Feature rich software including energy monitoring function Energy insight
- Integrated support for BMS/SCADA
- Prepared for Systemair Connect cloud solution

Easy installation

Topvex SC in size range 20, 25 and 35 are all single casing units for quick transportation into the facility and easy installation. Topvex SC in size range 60 and 70 are split units that can be divided for easy transport and installation.

True compact air handling unit

Topvex is a frameless design with optimised dimension that still allow for energy efficient operation. All built-in components are selected to minimize the usage of floorspace in the facility, in relation to the capacity they are designed for which results in a true compact air handling unit.

Ordering code:

- Model size: SC20, SC25, SC35, SC60, SC70
- Right or Left model: R (Right), L (Left). The side where the supply air is located when viewed from the access side.

Article name: Topvex SC20-L-EL4,2-B ODK | Product link: <https://shop.systemair.com/en-GB/productPermalink?p=826691> | Item Number: 281806 | Document type: Product card | Created at: 04.11.2022 | Generated by: Systemair Online Catalogue | Language: English

Page 1 of 7

Get In Touch



Call: 0845 6880112



Email: info@adremit.co.uk

Our Address

Puravent, Adremit Limited, Unit 5a, Commercial Yard,
Settle, North Yorkshire, BD24 9RH

- Heating coil: EL (Electric), HWL (Hot water coil-low power), HWH (Hot water coil-high power), None (No heater).
- Defrosting: S (Section defrosting), B (Bypass defrosting).



Technical parameters

Unit		
Frequency	60; 50	Hz
Voltage (nominal)	230	V
Phases	1~	
Recommended fuse	3x16 A	
Enclosure class	IP23	
Speed regulation	Stepless	
Air flow	0.0922 to 0.5722	m ³ /s
Product type	Heat recovery unit	
Preheater / Reheater		
Input power, reheater	4.2	kW
Voltage (nominal)	400	V
Phases	3~	
Supply fan		
Voltage	230	V
Phases	1~	
Input power (P1), supply fan	792	W
Supply air filter		
Filter class, supply air	ePM1 60%	
Extract air filter		
Filter class, extract air	ePM10 60%	
Exchanger		
Exchanger type	Counter flow	
Heater		
Phases	3~	
Return fan / Extract fan		
Voltage	230	V
Phases	1~	
Input power, extract fan	761	W

Article name: Topvex SC20-L-EL4,2-B ODK | Product link: <https://shop.systemair.com/en-GB/productPermalink?p=826691> | Item Number: 281806 | Document type: Product card | Created at: 04.11.2022 | Generated by: Systemair Online Catalogue | Language: English

Page 2 of 7

Get In Touch

 Call: 0845 6880112
 Email: info@adremit.co.uk

Our Address

Puravent, Adremit Limited, Unit 5a, Commercial Yard,
Settle, North Yorkshire, BD24 9RH





Others	
Size	20
Fan control	CAV, air flow control; Stepless voltage control
Installation placement	Horizontal
Supply side	Left

Dimensions and weights	
Weight	271 kg

Article name: Topvex SC20-L-EL4,2-B ODK | Product link: <https://shop.systemair.com/en-GB/productPermalink?p=826691> | Item Number: 281806 | Document type: Product card | Created at: 04.11.2022 | Generated by: Systemair Online Catalogue | Language: English

Get In Touch

 **Call:** [0845 6880112](tel:08456880112)
 **Email:** info@adremit.co.uk

Our Address

Puravent, Adremit Limited, Unit 5a, Commercial Yard,
Settle, North Yorkshire, BD24 9RH



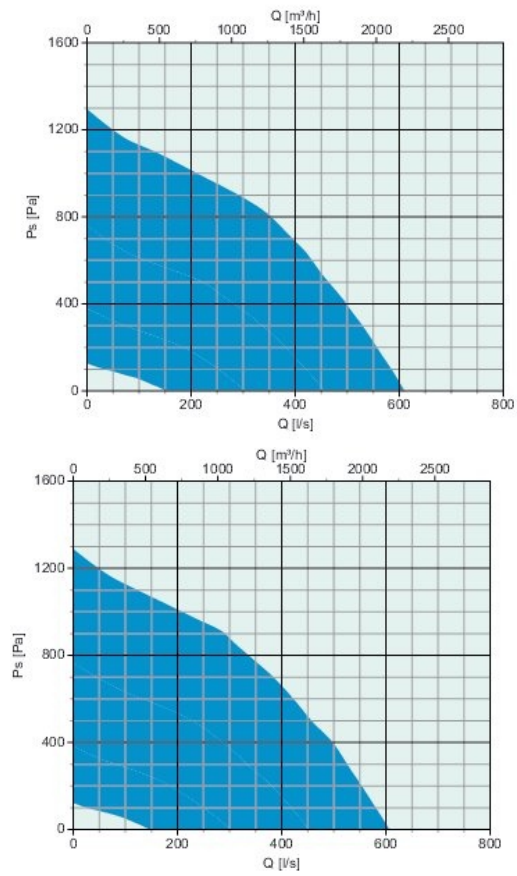

Performances



Article name: Topvex SC20-L-EL4,2-B ODK | Product link: <https://shop.systemair.com/en-GB/productPermalink?p=826691> | Item Number: 281806 | Document type: Product card | Created at: 04.11.2022 | Generated by: Systemair Online Catalogue | Language: English

Page 4 of 7

Get In Touch

 Call: 0845 6880112
 Email: info@adremit.co.uk

Our Address

Puravent, Adremit Limited, Unit 5a, Commercial Yard,
Settle, North Yorkshire, BD24 9RH

Dimension

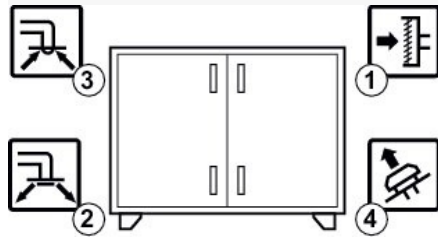
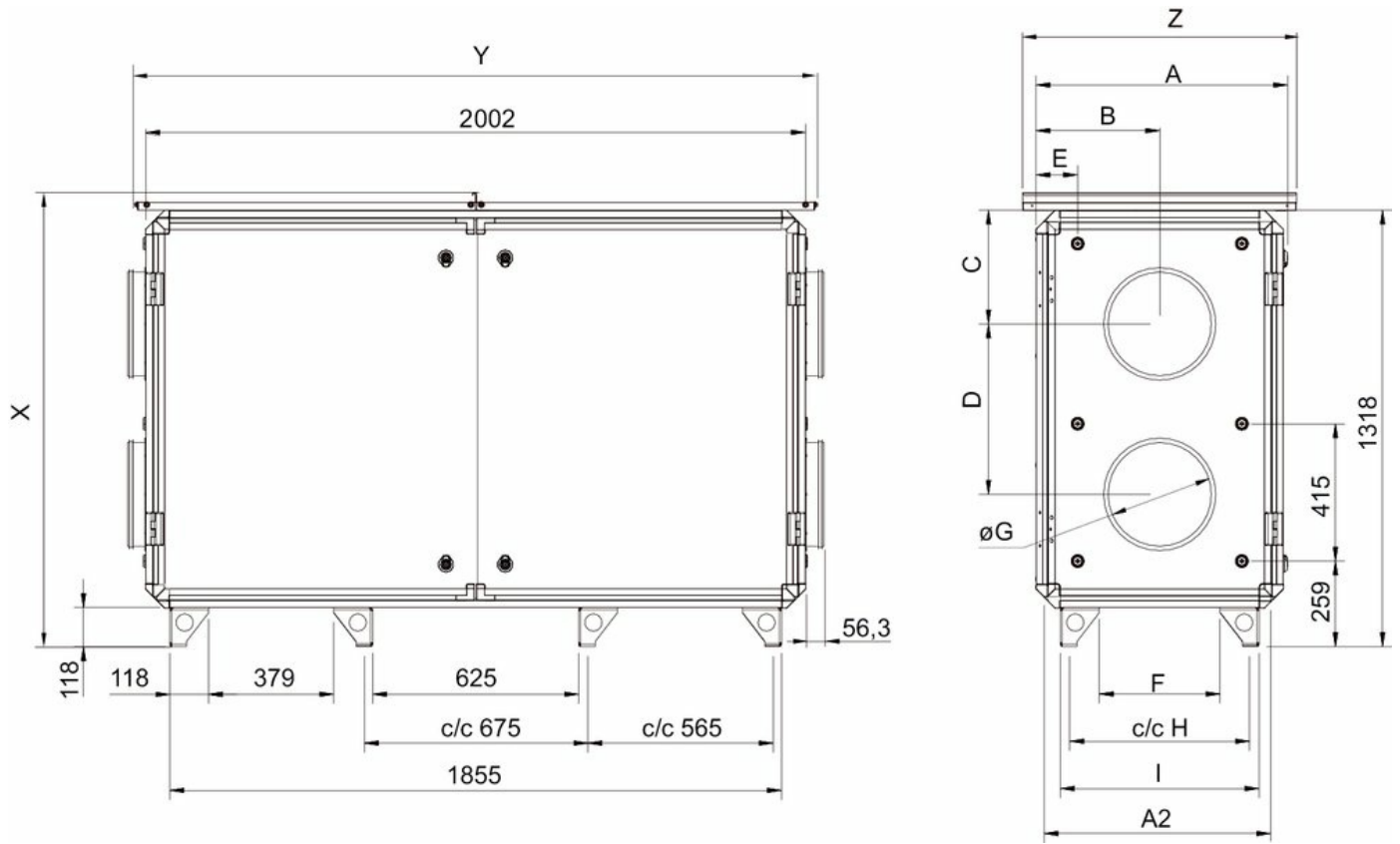

Symbol	Description
1	Outdoor air
2	Supply air
3	Extract air
4	Exhaust air

Article name: Topvex SC20-L-EL4,2-B ODK | Product link: <https://shop.systemair.com/en-GB/productPermalink?p=826691> | Item Number: 281806 | Document type: Product card | Created at: 04.11.2022 | Generated by: Systemair Online Catalogue | Language: English

Get In Touch

Call: 0845 6880112
Email: info@adremit.co.uk

Our Address

Puravent, Adremit Limited, Unit 5a, Commercial Yard,
Settle, North Yorkshire, BD24 9RH

Ecodesign

Product	
Trade name	Systemair
Product name	Topvex SC20
Ecodesign	
ErP compliance	2018
Unit category	NRVU
Unit type	BVU
Drive	Integrated VSD
Other	
Heat recovery type	Recuperative
Temperature ratio	83 %
qv nom	0.3 m³/s
P nom	0.489 kW
SFPint	928 W/(m³/s)
Face velocity	1 m/s
Ps nom	200 Pa
Ps int. Supply	260 Pa
Ps int. Extract	264 Pa
Supply Fan efficiency	56.5 %
Extract fan efficiency	56.6 %
External Leakage	1 %
Internal Leakage	2 %
Filter energy performance	726 kWh
Sound power level LWA	47 dB(A)

Article name: Topvex SC20-L-EL4,2-B ODK | Product link: <https://shop.systemair.com/en-GB/productPermalink?p=826691> | Item Number: 281806 | Document type: Product card | Created at: 04.11.2022 | Generated by: Systemair Online Catalogue | Language: English

Page 6 of 7

Get In Touch

 Call: [0845 6880112](tel:08456880112)
 Email: info@adremit.co.uk

Our Address

Puravent, Adremit Limited, Unit 5a, Commercial Yard,
Settle, North Yorkshire, BD24 9RH

Accessories

- ASF 315/KB Flex. connection (2718)
- TG-R5/PT1000 Room sensor 0-50° (5404)
- DXRE 50-25-3-2,5 Duct cooler (7952)
- LDC 315-900 Silencer (5197)
- PGK 50-25-3-2,0 Duct cooler (6606)
- VBC 315-3 Water heating batt (9844)
- BFT SC20 Filter Ext ePM10 60% (213212)
- Connectduct Ø 315/1,0 M/F (2562)
- NaviPad extension cable 10m (316350)
- PFT SC20 Kit Coarse 60% (282025)
- PH Topvex 9kW 315 (235486)
- SPLIT-AHU Kit 0-10V LNS (215221)
- TUNE-R-315-3-LF24 (79890)
- ZTR 15-1,0 valve 3-way (9672)
- Presence detector/IR24-P (6995)
- VAV Air Volume Control (145946)
- FFR 315 Filter cassette (1779)
- LDC-B 315-1200 Silencer baffle (9068)
- VBC 315-2 Water heating batt (5461)
- BFT Deltri+ SC20 Filter Ext (890773)
- BFT SC20 Filter Sup ePM1 60% (213211)
- HMM Tube Humidistat IP 54 (13209)
- PFT Panelfilter SC 20 (282055)
- PH Topvex 6kW 315 (235489)
- RVAZ4 24A Actuator 0-10V (9862)
- TG-KH/PT1000 Duct sensor (202705)
- Water-lock (206263)
- ZTV 15-1,0 2-way valve (9823)

Documents

- ACCESS_QUICK_CONFIG_GUIDE_SW_4_0_1_05_157618_EN.PDF
- Communication Manual
- Configuration Manual
- Installation Instruction
- Operation and Maintenance Instructions
- QUICK_CONFIGURATION_GUIDE_ACCESS_SW_4_0-1-04_TO_4_6-1-00_157618_EN_A008.PDF
- Certificate VDI 6022
- Eurovent Certification Diploma Topvex
- Commissioning Record
- WD000144_EN_A006.PDF

Article name: Topvex SC20-L-EL4,2-B ODK | Product link: <https://shop.systemair.com/en-GB/productPermalink?p=826691> | Item Number: 281806 | Document type: Product card | Created at: 04.11.2022 | Generated by: Systemair Online Catalogue | Language: English

Page 7 of 7

Get In Touch



Call: [0845 6880112](tel:08456880112)



Email: info@adremmit.co.uk

Our Address

Puravent, Adremmit Limited, Unit 5a, Commercial Yard,
Settle, North Yorkshire, BD24 9RH