



KVK SILENT 200 EC

Item no. 92170



Description

- Low sound level, thick and high density insulation
- Compact design, easy installation
- Easy maintenance, service cover
- Air tight design
- High efficiency and low SFP in a real working point
- Potentiometer included, possible to speed control 0-100%
- Simple to install, mounting brackets included
- Integrated motor protection
- Aluzinc casing, C4 corrosion class

KVK Silent is a box fan with circular duct connections. The casing is insulated with thick and high density mineral wool insulation. The casing is manufactured from Aluzinc in corrosion class C4.

KVK Silent EC is delivered with integrated motor protection and pre-wired potentiometer (0-10V) that allows you to easily find the desired working point. The fan can be demand controlled via sensors for CO2, temperature, humidity, presence indication and VAV. Size 315-500 also offers possibility to communication via Modbus.

KVK Silent can be installed in any position.

The FK mounting clamp (accessory) facilitates easy installation and removal and prevents the transfer of vibration to the duct.



Technical parameters

Nominal data		
Voltage	230	V
Frequency	50/60	Hz
Phase	1	~
Input power (P1)	120	W
Current	0,929	A
Max. airflow	0,259	m³/s
R.p.m.	2479	r.p.m.
Weight	21	kg
Temperature data		
Max. temperature of transported air	60	°C
Max. temperature of transported air when speed-controlled	60	°C
Sound data		
Sound pressure level at 3 m	41,9	dB(A)
Protection / Classification		
Insulation class	B	
Enclosure class, motor	IP54	

Get In Touch

Call: [0845 6880112](tel:08456880112)
 Email: info@adremit.co.uk

Our Address

Puravent, Adremit Limited, Unit 5a, Commercial Yard, Settle, North Yorkshire, BD24 9RH



ErP

Energy class, basic unit

E

Energy class, basic unit option

B

ErP ready

ErP 2018

Energy class label

Energy class, basic unit

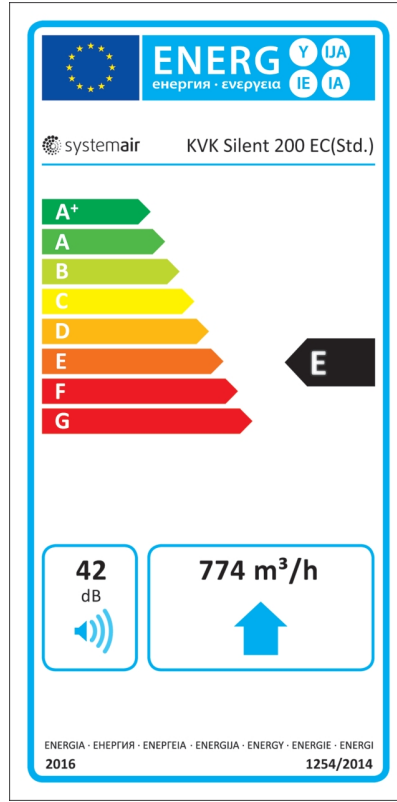

Name: **KVK SILENT 200 EC** | Item no.: **92170**

2 / 6

Document type: **Product card** | Document date: **2019-07-10** | Generated by: **Online catalogue**

Get In Touch

Call: [0845 6880112](tel:08456880112)
Email: info@adremit.co.uk

Our Address

Puravent, Adremit Limited, Unit 5a, Commercial Yard,
Settle, North Yorkshire, BD24 9RH

Energy class, unit with local demand control

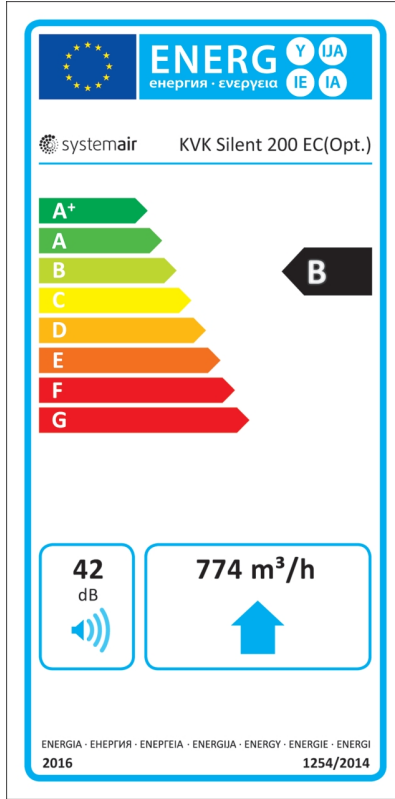

Diagrams

Diagrams

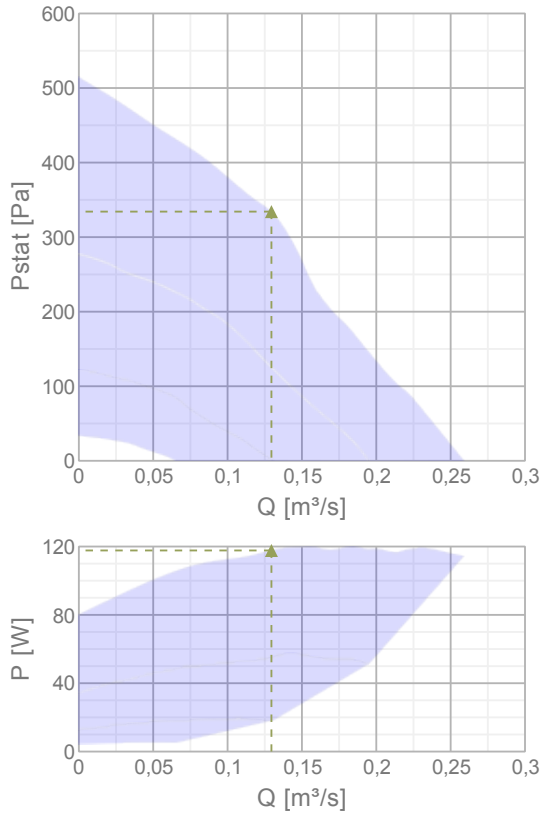

Name: **KVK SILENT 200 EC** | Item no.: **92170**

3 / 6

Document type: **Product card** | Document date: **2019-07-10** | Generated by: **Online catalogue**

Get In Touch

Call: [0845 6880112](tel:08456880112)
 Email: info@adremit.co.uk

Our Address

Puravent, Adremit Limited, Unit 5a, Commercial Yard,
 Settle, North Yorkshire, BD24 9RH

Max efficiency

Hydraulic data										
▲ Working air flow										0,129 m ³ /s
▲ Working static pressure										334 Pa
▲ Power										118 W
Speed										2547 r.p.m.
Current										0,909 A
SFP										0,909 W/(l/s)
Voltage										230 V
Sound power level		63	125	250	500	1k	2k	4k	8k	Tot
Inlet	dB(A)	53	56	62	56	49	47	45	44	64
Outlet	dB(A)	51	54	63	60	58	60	53	45	67
Surrounding	dB(A)	30	33	47	42	40	29	27	29	49

Dimensions

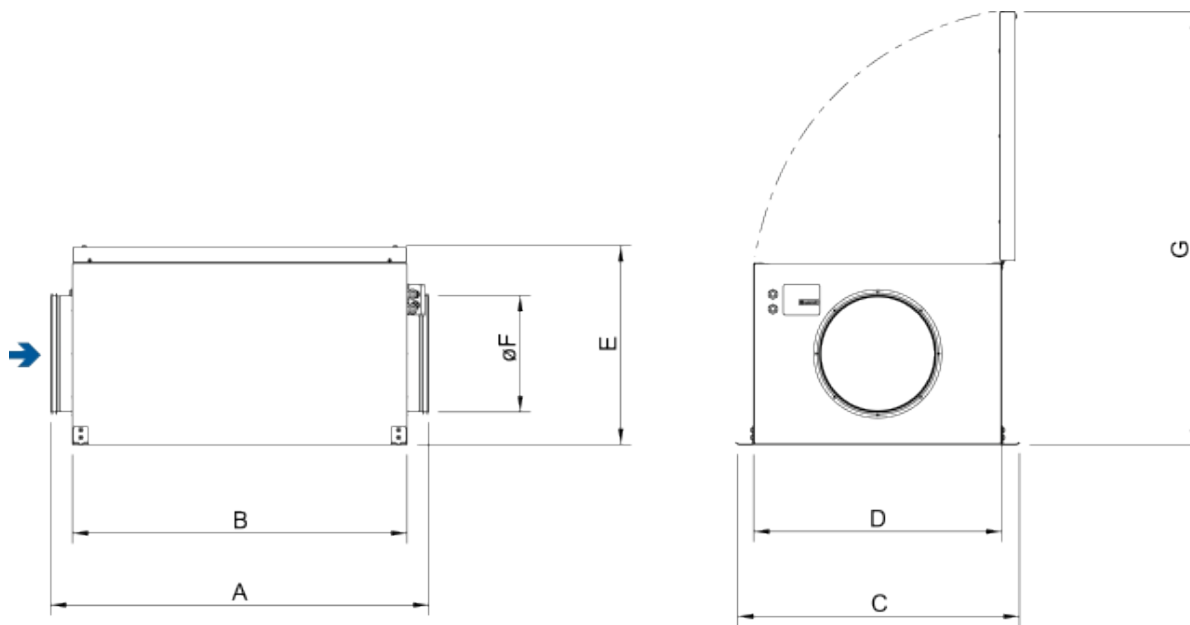

KVK SILENT	A	B	C	D	E	øF	G
200 AC/EC	682	604	596	500	352	200	810

Name: **KVK SILENT 200 EC** | Item no.: **92170**

Document type: **Product card** | Document date: **2019-07-10** | Generated by: **Online catalogue**

4 / 6

Get In Touch

Call: [0845 6880112](tel:08456880112)
 Email: info@adremit.co.uk

Our Address

Puravent, Adremit Limited, Unit 5a, Commercial Yard,
 Settle, North Yorkshire, BD24 9RH

Wiring

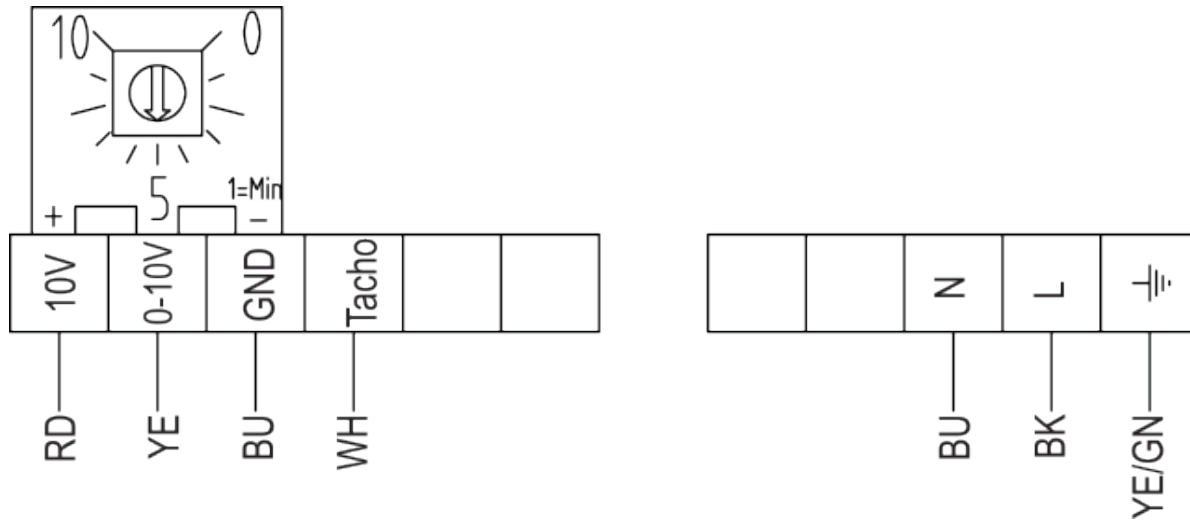

RD	Red
YE	Yellow
BU	Blue
WH	White
GN	Green
BN	Brown
BK	Black

Accessories

Electric accessories

- [RT 0-30 Room Thermostat \(5151\)](#)
- [CO2RT-R-D Transmitter \(6993\)](#)
- [Presence detector/IR24-P \(6995\)](#)
- [MTV-1/010 Controller 0..10V+ \(30650\)](#)
- [DMD-C Pressure controller \(15793\)](#)
- [MTP 10, 10K, Speed control \(32731\)](#)
- [EC-Vent Room Unit \(3018\)](#)
- [EC-Vent control board \(3115\)](#)
- [REV-3POL/03 ON/OFF \(33978\)](#)
- [MTP 20, on/off, 3-step \(310220\)](#)
- [EC-Basic-H humidity \(24807\)](#)
- [EC-Basic-T temperature \(24805\)](#)
- [EC-Basic-U universal 0-10V \(24806\)](#)
- [EC-Basic-CO2 and temperature \(24808\)](#)
- [EC-Selector \(9908\)](#)
- [CXE/AVC Modbus \(37256\)](#)
- [S-5EC/FRQ \(76738\)](#)

Get In Touch

-  **Call:** [0845 6880112](tel:08456880112)
-  **Email:** info@adremit.co.uk

Our Address

Puravent, Adremit Limited, Unit 5a, Commercial Yard,
Settle, North Yorkshire, BD24 9RH

Accessories

[CB 200-3,0 230V/1 Duct heater \(5370\)](#)
[CB 200-2,1 230V/1 Duct heater \(5384\)](#)
[CBM 200-5,0 400V/2 Duct heater \(5483\)](#)
[VBF 200 Water heating battery \(1732\)](#)
[CWK 200-3-2,5 Duct cooler,circ \(30023\)](#)
[VBC 200-2 Water heating batt \(5459\)](#)
[LDC 200-600 Silencer \(5194\)](#)
[LDC 200-900 Silencer \(5195\)](#)
[FFR 200 Filter cassette \(1773\)](#)
[FGR 200 Filter cassette \(1812\)](#)
[FK 200 Fast clamp \(1611\)](#)
[VKK-200 Back draft damper \(1626\)](#)
[IGK-200 Wall Grid \(1633\)](#)
[RSK-200 Back draft damper \(5602\)](#)
[SG 200 Protection guard \(5609\)](#)
[VK-20 Louvre shutter \(5639\)](#)
[VBC 200-3 Water heating batt \(9841\)](#)
[LDC 200-300 Silencer \(53369\)](#)
[THB 200 Hood w.cover pl. black \(134465\)](#)
[CB 200/S1/3,0KW 400V/2Duct hea \(5294\)](#)
[CB 200-5,0 400V/2 Duct heater \(5371\)](#)

Documentation



[KVK_Silent_Slim_Operating_maintenance_145899_CE_EN_A007.pdf \(1,47MB\)](#)

Name: **KVK SILENT 200 EC** | Item no.: **92170**

Document type: **Product card** | Document date: **2019-07-10** | Generated by: **Online catalogue**

6 / 6

Get In Touch



Call: [0845 6880112](tel:08456880112)



Email: info@adremit.co.uk

Our Address

Puravent, Adremit Limited, Unit 5a, Commercial Yard,
Settle, North Yorkshire, BD24 9RH