



KBR 315EC THERMO FAN

Item no. 33397

Document type: **Product card**
 Document date: **2019-07-16**
 Generated by: **Systemair Online Catalogue**

Description

- EC-motors, high level of efficiency
- 100% speed controllable
- Integrated motor protection
- Low noise level
- Max. temp. of continuous transported air 120°C

EC technology is intelligent technology; using integral electronic control which eliminates the slip losses in the motor and ensures that the motor always runs at optimal load and guarantees that the proportion of energy utilized effectively is many times higher and the energy usage considerably lower compared with AC motors. EC fans are notable for their economical use of energy and excellent ease of control. They can be varied in speed to match the airflow demand, and operate at high efficiency levels. For the same air volume, they consume distinctly less energy than AC fan drives. Another special feature of EC fans is their energy-saving potential not only at full load, but especially at part-load. When operating at part load, the energy used is much lower than with an asynchronous motor of equivalent output. Reduced energy usage guarantees a drop in operating costs. The power electronics are integrated in the motor housing. All models have one potential-free terminal for error message. All motors are suitable to be used for 50/60Hz. The input voltage for single phase units can vary between 200 and 277V and three phase between 380 and 480V. Speed control by a 0-10V signal. Every motor has an output voltage of 10V for an external potentiometer or sensor. The KBR-EC fans have impellers manufactured from galvanized sheet steel with backward-curved blades. The casing is manufactured from double-skinned galvanized sheet steel and is insulated with 50 mm mineral wool. The KBR-EC fans have a swing-out door for easy inspection and service. The fan is isolated from the casing via connectors and anti-vibration dampers are incorporated into the base frame.



Technical parameters

Nominal data	
Voltage	230 V
Frequency	50/60 Hz
Phase	1 ~
Input power (P1)	182 W
Current	0,772 A
Max. airflow	0,617 m³/s
R.p.m.	1512 r.p.m.
Weight	55 kg
Temperature data	
Max. temperature of transported air	120 °C
Sound data	
Sound pressure level at 4 m	26 dB(A)
Protection / Classification	
Insulation class	F
Enclosure class, motor	IP55
Default group	
Sound pressure level at 10 m	18 dB(A)

Get In Touch

Call: 0845 6880112
 Email: info@adremit.co.uk

Our Address

Puravent, Adremit Limited, Unit 5a, Commercial Yard,
 Settle, North Yorkshire, BD24 9RH



Diagrams

Diagrams

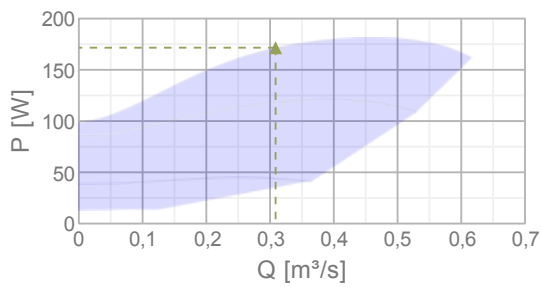
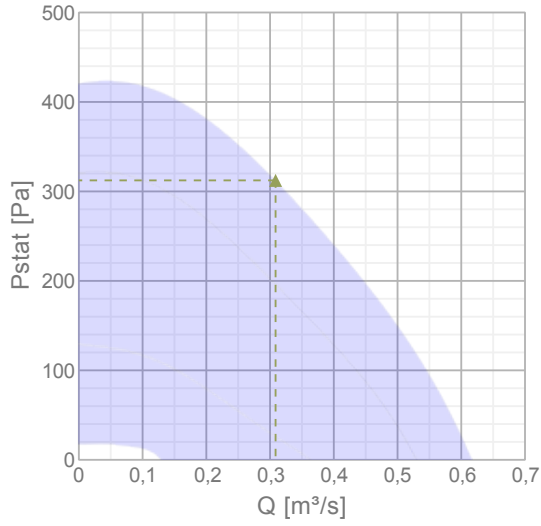

Max efficiency

Hydraulic data										
▲ Working air flow	0,309 m³/s									
▲ Working static pressure	312 Pa									
▲ Power	172 W									
Speed	1512 r.p.m.									
Current	0,73 A									
SFP	0,556 W/(l/s)									
Voltage	230 V									
Sound power level		63	125	250	500	1k	2k	4k	8k	Tot
Inlet	dB(A)	46	58	64	65	58	58	55	50	69
Outlet	dB(A)	47	59	66	66	61	60	54	48	71
Surrounding	dB(A)	16	39	45	40	45	36	35	25	49

Get In Touch

 **Call:** [0845 6880112](tel:08456880112)
 **Email:** info@adremit.co.uk

Our Address

Puravent, Adremit Limited, Unit 5a, Commercial Yard,
Settle, North Yorkshire, BD24 9RH

Dimensions

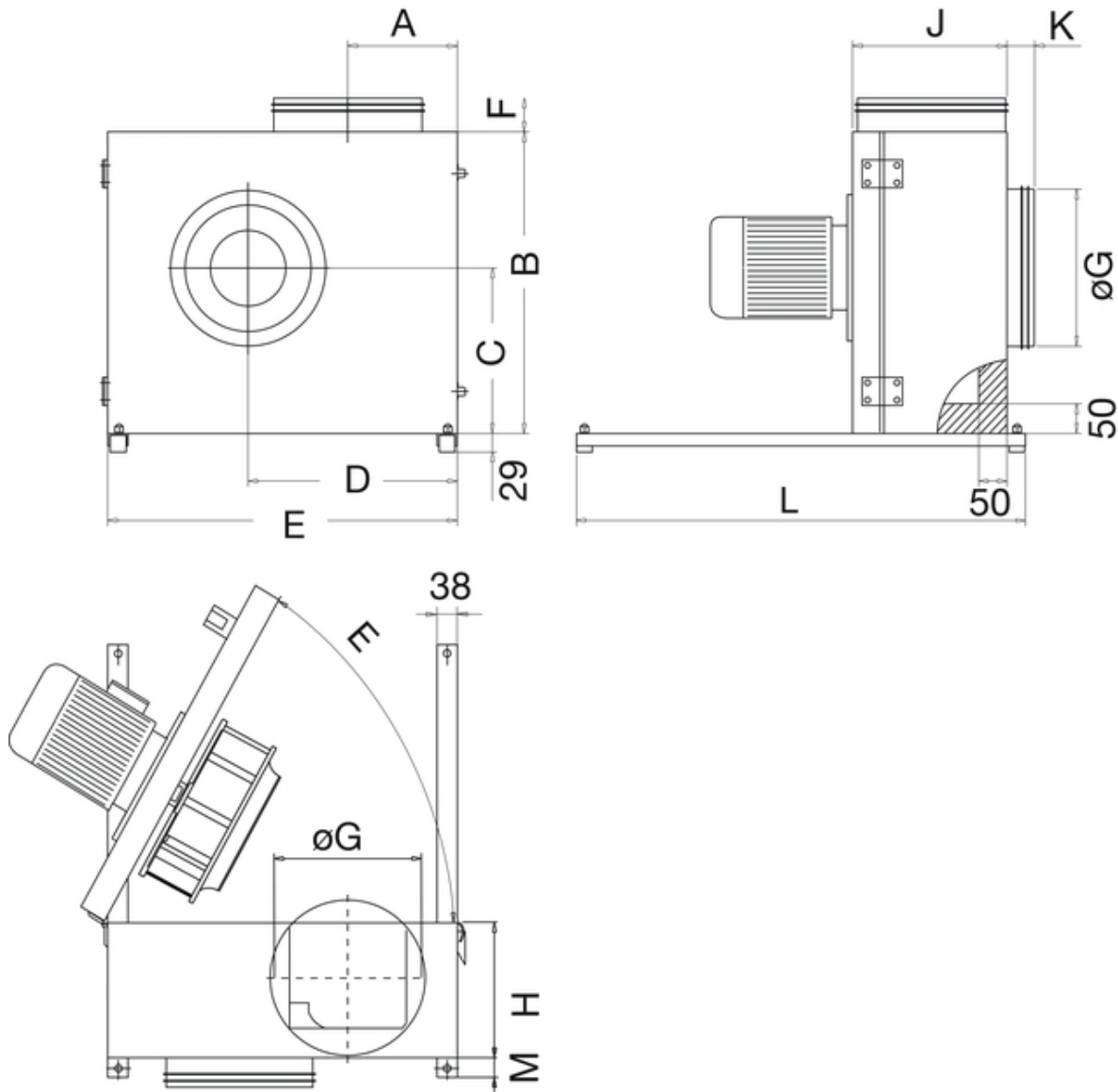

KBR	A	B	C	D	E	F	øG	H	J	K	L	M
315	187,5	600	339	398	690	125	315	249	307	70	770	55

Accessories

Electric accessories

- [RT 0-30 Room Thermostat \(5151\)](#)
- [CO2RT-R-D Transmitter \(6993\)](#)
- [Presence detector/IR24-P \(6995\)](#)
- [MTV-1/010 Controller 0..10V+ \(30650\)](#)
- [MTP 10, 10K, Speed control \(32731\)](#)
- [EC-Vent Room Unit \(3018\)](#)
- [EC-Vent control board \(3115\)](#)
- [REV-3POL/03 ON/OFF \(33978\)](#)
- [MTP 20, on/off, 3-step \(310220\)](#)
- [EC-Basic-H humidity \(24807\)](#)
- [EC-Basic-T temperature \(24805\)](#)
- [EC-Basic-U universal 0-10V \(24806\)](#)
- [EC-Basic-CO2 and temperature \(24808\)](#)
- [CXE/AVC Modbus \(37256\)](#)
- [S-5EC/FRQ \(76738\)](#)

Name: **KBR 315EC THERMO FAN** | Item no.: **33397**

Document type: **Product card** | Document date: **2019-07-16** | Generated by: **Online catalogue**

3 / 4

Get In Touch

 **Call:** [0845 6880112](tel:08456880112)
 **Email:** info@adremit.co.uk

Our Address

Puravent, Adremit Limited, Unit 5a, Commercial Yard,
Settle, North Yorkshire, BD24 9RH

Accessories

[ASF 315/KB Flex. connection \(2718\)](#)

[WBK 315/355 Wall bracket \(2721\)](#)

[ALS-KBR drain plug \(2727\)](#)

[WSD KBR-1 Weather roof f.motor \(2728\)](#)

Documentation

 [manual_kbr_en_\[003\].pdf \(3,41MB\)](#)

 [eu declaration of conformity_thermofans_en_\[002\].pdf \(46,39kB\)](#)

Specification text

Kitchen exhaust fan for medium temperatures up to 120 °C in continuous operation, reliable, swing-out service door incl. motor section, motor outside air flow. Casing made of double-skinned galvanised steel sheet, insulated with 50 mm rock wool, non-combustible according to A1 DIN 4102. Swing-out door for easy inspection and service of impeller and motor, completely swing out to the outside. Backward curved centrifugal impeller made of aluminium. Impeller acc. to VDI 2060, balancing quality Q 6.3, dynamically balanced in two planes acc. to ISO 1940 T1. Energy-saving, energy-efficient EC compact motor, maintenance-free, outside the air flow. Integrated, electronic motor protection. Terminal box incl. Suction and discharge sided duct connection with rubber-lip seal. Top discharge. With protection plate to avoid condensate leakage. Low sound level. Indoor installation, outdoor installation with weather roof (WSD). Delivery with mounting rails and rubber vibration dampers.

Get In Touch



Call: [0845 6880112](tel:08456880112)



Email: info@adremit.co.uk

Our Address

Puravent, Adremit Limited, Unit 5a, Commercial Yard,
Settle, North Yorkshire, BD24 9RH