

Accessories for MUB

From duct fan to small ventilation unit



Get In Touch



Call: [0845 6880112](tel:08456880112)



Email: info@adremit.co.uk

Our Address

Puravent, Adremit Limited, Unit 5a, Commercial Yard,
Settle, North Yorkshire, BD24 9RH

Application Areas

MUB duct fan –

All-rounder for (almost) every application



Get In Touch

 Call: [0845 6880112](tel:08456880112)
 Email: info@adremit.co.uk

Our Address

Puravent, Adremit Limited, Unit 5a, Commercial Yard,
Settle, North Yorkshire, BD24 9RH

Our duct fans of the MUB series were developed for both supply and exhaust ventilation. Due to many different product variations, the fan can be used in numerous application areas.



Supply / exhaust air, no special requirements | MUB



Supply / exhaust air, constant pressure or constant air | MUB-CAV/VAV



Kitchen exhaust air | MUB/T und MUB/T-S



Explosion-proof | MUB-EX*



Fire safety | MUB/F*

* The accessories presented on the following pages are not suitable due to the special use of variants (high temperatures and explosive-protection).



Get In Touch



Call: [0845 6880112](tel:08456880112)



Email: info@adremit.co.uk

Our Address

Puravent, Adremit Limited, Unit 5a, Commercial Yard,
Settle, North Yorkshire, BD24 9RH



Accessories for our MUB fans

Small ideas with big added value



Thanks to the wide range of accessories, the MUB is now even more versatile. *Filter, heater, cooler and silencer modules* are available, as well as various *base frames and roofs*. With the use of these, your duct fan becomes a small air handling unit.

All accessory components can now be selected and ordered online. It's easy and saves time! Browse through this brochure to find out which accessories we have in store for you and with which MUB you can use them efficiently.

CONNECTING MATERIAL

Each module comes with connection material, so you can realize your projects in an uncomplicated way.

Original pays off:

- *Exact fit*
- *Easy installation and mounting*
- *Intelligent complete solutions*



Get In Touch

 Call: [0845 6880112](tel:08456880112)
 Email: info@adremit.co.uk

Our Address

Puravent, Adremit Limited, Unit 5a, Commercial Yard,
Settle, North Yorkshire, BD24 9RH

Combination examples

From duct fan to small ventilation unit

KKF-KITCHEN + MUB T EC



KKF + MUB EC + KKF

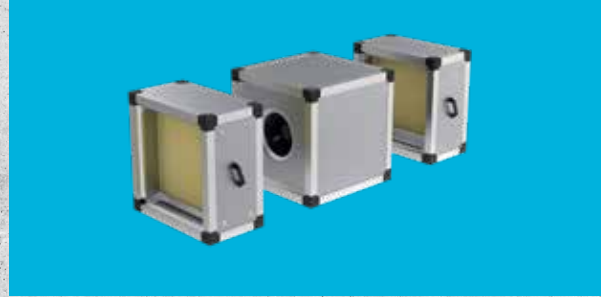

KKF + MUB EC + KKH + KKC



KKF + MUB EC + WSD + MUB + KKF

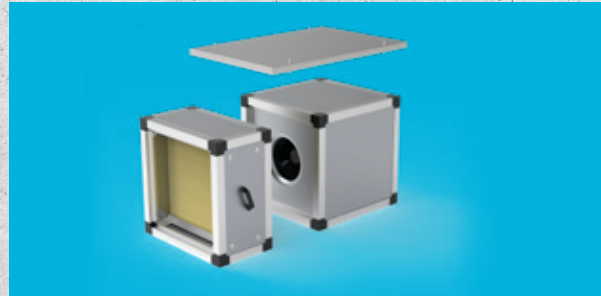

KKF-ALU + KKF + MUB TS EC + KKF-CAR



KKF-ALU + MUB T EC



KKS + MUB EC + KKS



KKF and KKH: The casing is a self-supporting construction of aluminium profile. Double skin panels made of galvanised sheet steel, with 30 mm sound and heat insulation made of mineral wool. Corners made of high shock-resistant plastic type PA6.

This fits exactly to our Multiboxes (MUB) in terms of dimensions and design, therefore it is directly connectable to the suitable Multibox. The necessary connecting material is already enclosed. The filter-module can be mounted horizontally or vertically.

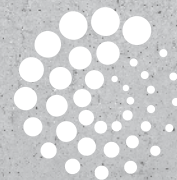

Get In Touch

 Call: 0845 6880112
 Email: info@adremit.co.uk

Our Address

Puravent, Adremit Limited, Unit 5a, Commercial Yard,
Settle, North Yorkshire, BD24 9RH

Advantages

Your advantages at a glance



Short delivery times

We keep the accessories for our MUB in stock for you. So you do not have to wait long for your order.



Simple and quick selection and ordering

Each accessory has an individual article number and can be easily found in our online catalog at www.systemair.de. Use the Systemair WEBSHOP as the most convenient way to order the required articles.



One-stop shop

Our accessories are matched to our MUB fans in every detail. There are no adapters necessary, which simplifies both planning and installation.



Time-saving installation



The supplied mounting and connecting material ensures simple and quick installation. There is no need for you to purchase it separately.

Systemair WEBSHOP and Project Planner:

The accessories for MUB fans can be ordered quickly and easily via our WEBSHOP. Using this convenient way you can also track the status of your order and shipment. Our project planner helps you to create a clear product documentation in a time-saving way: Simply add the desired MUB to the project and the appropriate accessories will be added automatically. In addition, current prices and availabilities are displayed.



Get In Touch

 **Call:** 0845 6880112
 **Email:** info@adremit.co.uk

Our Address

Puravent, Adremit Limited, Unit 5a, Commercial Yard,
Settle, North Yorkshire, BD24 9RH



systemair 7

Get In Touch



Call: [0845 6880112](tel:08456880112)



Email: info@adremit.co.uk

Our Address

Puravent, Adremit Limited, Unit 5a, Commercial Yard,
Settle, North Yorkshire, BD24 9RH



KKF – filter section



KKF – Filter module for MUB

The filter module is designed to support panel-filters of filter classes ePM10 60 %, ePM1 55 % and ePM1 85 % (formerly M5, F7 and F9). The filter can be replaced via a removable inspection-panel.

The filter-module can be mounted horizontally or vertically. The panel-filters must be ordered separately.

Technical parameters

KKF	Item no.
025	93310
042	93311
062	93312
100	93313

Dimensions

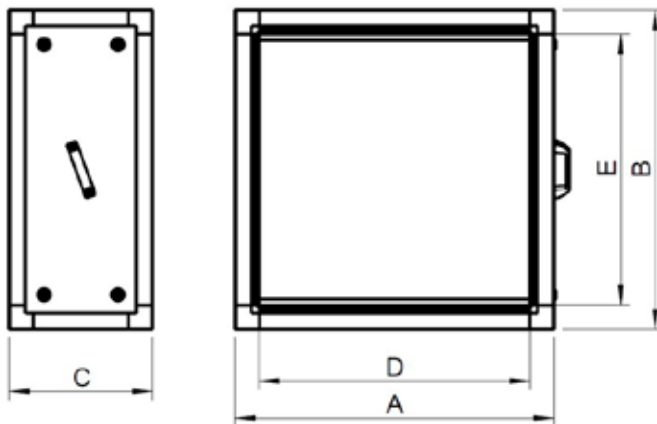

Type	Filter panel	Item no.	W x H x T (mm)	Quantity
KKF 025	M5 / ePM10 60%	303587	455x375x94	1
	F7 / ePM1 55%	303588	455x375x94	1
	F9 / ePM1 85%	303589	455x375x94	1
KKF 042	M5 / ePM10 60%	303571	615x545x94	1
	F7 / ePM1 55%	303572	615x545x94	1
	F9 / ePM1 85%	303573	615x545x94	1
KKF 062	M5 / ePM10 60%	303575	755x675x94	1
	F7 / ePM1 55%	303576	755x675x94	1
	F9 / ePM1 85%	303577	755x675x94	1
KKF 100	M5 / ePM10 60%	303579	875x477x94	2
	F7 / ePM1 55%	303580	875x477x94	2
	F9 / ePM1 85%	303581	875x477x94	2

KKF	A	B	C	D	E
KKF 025	520 mm	520 mm	378 mm	378 mm	378 mm
KKF 042	690 mm	690 mm	378 mm	548 mm	548 mm
KKF 062	820 mm	820 mm	378 mm	678 mm	678 mm
KKF 100	1020 mm	1020 mm	520 mm	878 mm	878 mm

Get In Touch

Call: 0845 6880112
Email: info@adremit.co.uk

Our Address

Puravent, Adremit Limited, Unit 5a, Commercial Yard, Settle, North Yorkshire, BD24 9RH



Performances

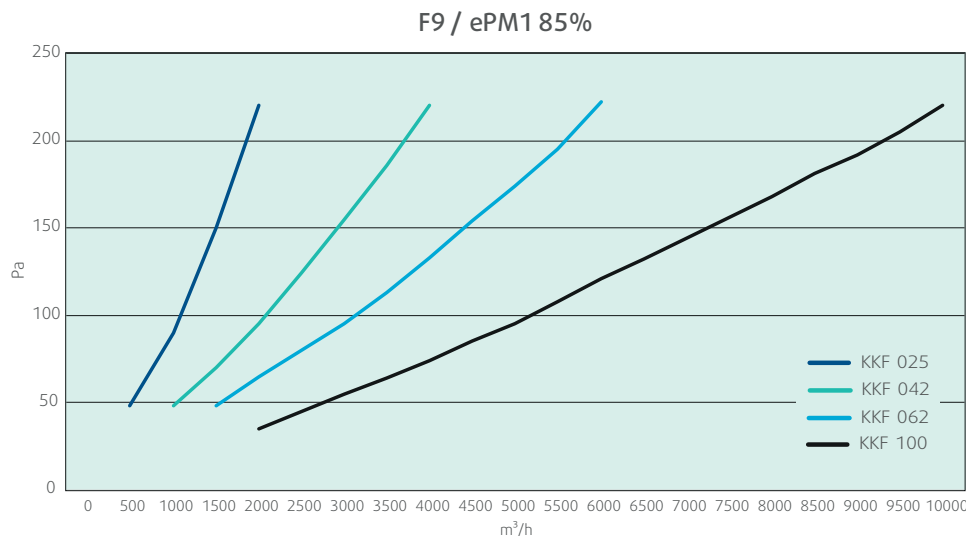
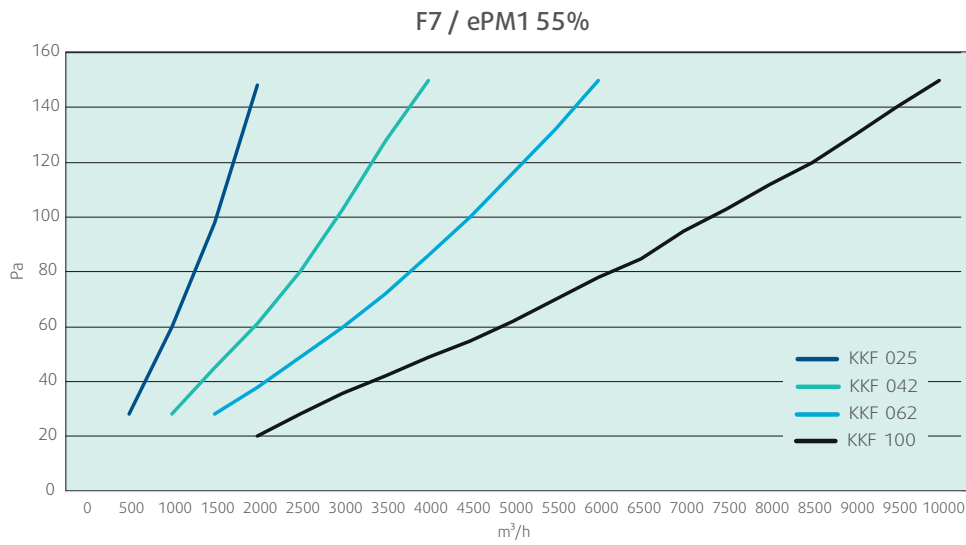
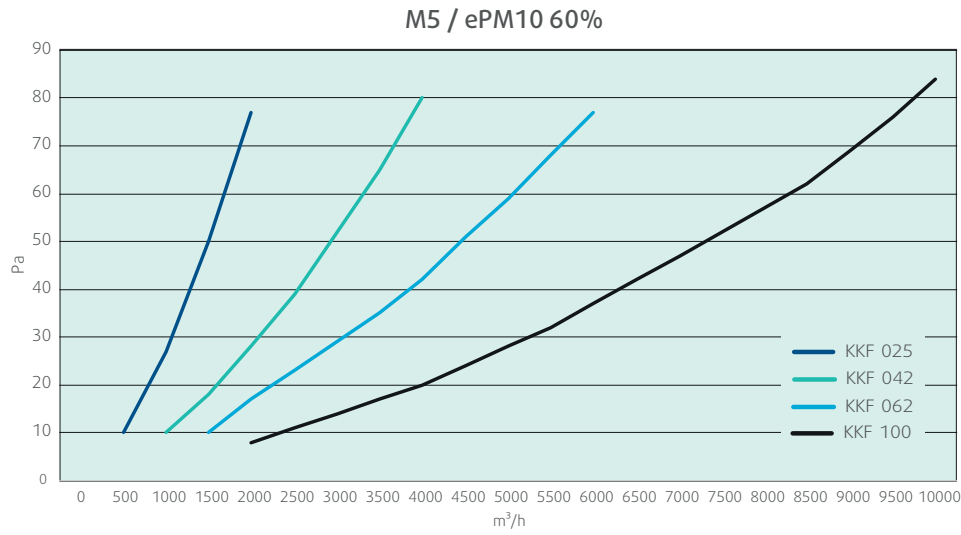

Get In Touch

Call: [0845 6880112](tel:08456880112)
 Email: info@adremit.co.uk

Our Address

Puravent, Adremit Limited, Unit 5a, Commercial Yard,
 Settle, North Yorkshire, BD24 9RH





KKF-ALU – filter section



KKF-ALU – Filter-section for MUB/T

The filter module is equipped with an aluminium-mesh panelfilter and an aluminium drip tray. The removable inspection-panel allows to pull out the filter together with the drip tray sideways.

Technical parameters

KKF-ALU	Item no.
025	376814
042	376815
062	376816
100	376817

Dimensions

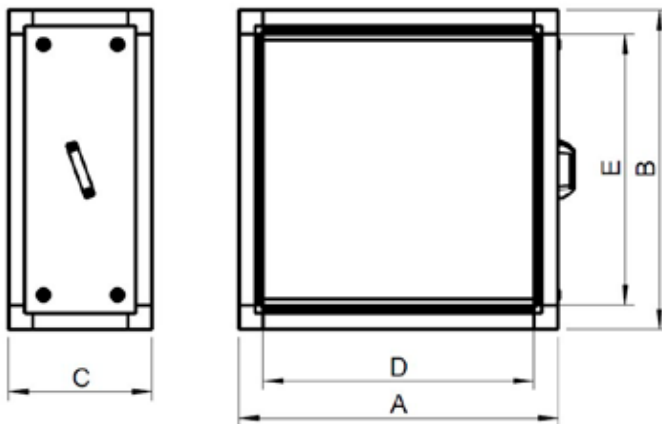

Type	Alu-Filter		
	Item no.	W x H x T (mm)	Quantity
KKF-ALU 025	303535	375x455x48	1
KKF-ALU 042	303540	625x545x48	1
KKF-ALU 062	303541	755x675x48	1
KKF-ALU 100	303539	875x314x48	3

KKF	A	B	C	D	E
KKF-ALU 025	520 mm	520 mm	378 mm	378 mm	378 mm
KKF-ALU 042	690 mm	690 mm	378 mm	548 mm	548 mm
KKF-ALU 062	820 mm	820 mm	378 mm	678 mm	678 mm
KKF-ALU 100	1020 mm	1020 mm	520 mm	878 mm	878 mm

Get In Touch

Call: 0845 6880112
Email: info@adremit.co.uk

Our Address



Puravent, Adremit Limited, Unit 5a, Commercial Yard, Settle, North Yorkshire, BD24 9RH

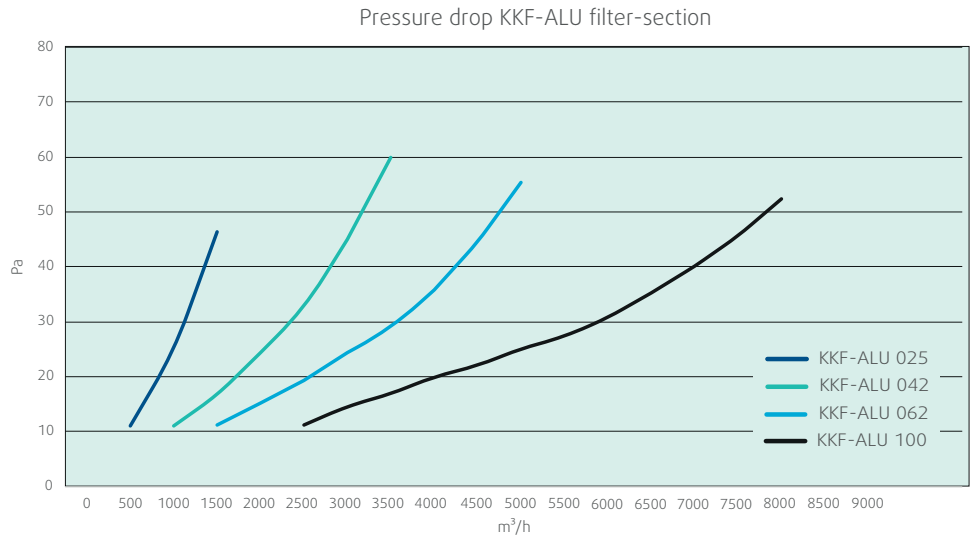

Performances



Get In Touch

 Call: [0845 6880112](tel:08456880112)
 Email: info@adremit.co.uk

Our Address

Puravent, Adremit Limited, Unit 5a, Commercial Yard,
Settle, North Yorkshire, BD24 9RH





KKF-CAR – filter section



KKF-CAR – Filter-section for MUB/T

The filter module is equipped with a carbon-cartridge-filter. The removable inspection-panel give you access for maintenance. The access-side can be changed on site.

For maximum efficiency of the carbon-odor-filter, the contact time should be 0.2 seconds, until 0.1 seconds an odor-reduction can be achieved. See contact-time-diagram.

The filter-module can be operated temporarily at higher air volumes for maximum air exchange, according to the curve. At this range with minimal odor-reduction.

Technical parameters

KKF-CAR	Item no.
042	277346
062	277347
100	277348
127	277349

Dimensions

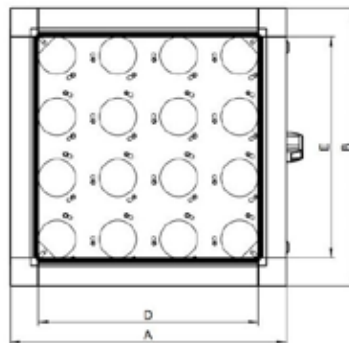
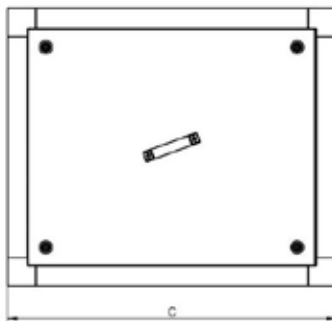

Type	carbon-cartridge-filter		
	Item no.	D x L (mm)	Quantity
KKF-CAR 042	303522	145x450	16
KKF-CAR 062	303522	145x450	25
KKF-CAR 100	303522	145x450	32
KKF-CAR 127	303522	145x450	64

KKF	A	B	C	D	E
KKF-CAR 042	690 mm	690 mm	820 mm	548 mm	548 mm
KKF-CAR 062	820 mm	820 mm	820 mm	678 mm	678 mm
KKF-CAR 100	1020 mm	1020 mm	820 mm	878 mm	878 mm
KKF-CAR 127	1290 mm	1290 mm	820 mm	1148 mm	1148 mm

Get In Touch

Call: 0845 6880112
Email: info@adremit.co.uk



Our Address

Puravent, Adremit Limited, Unit 5a, Commercial Yard, Settle, North Yorkshire, BD24 9RH

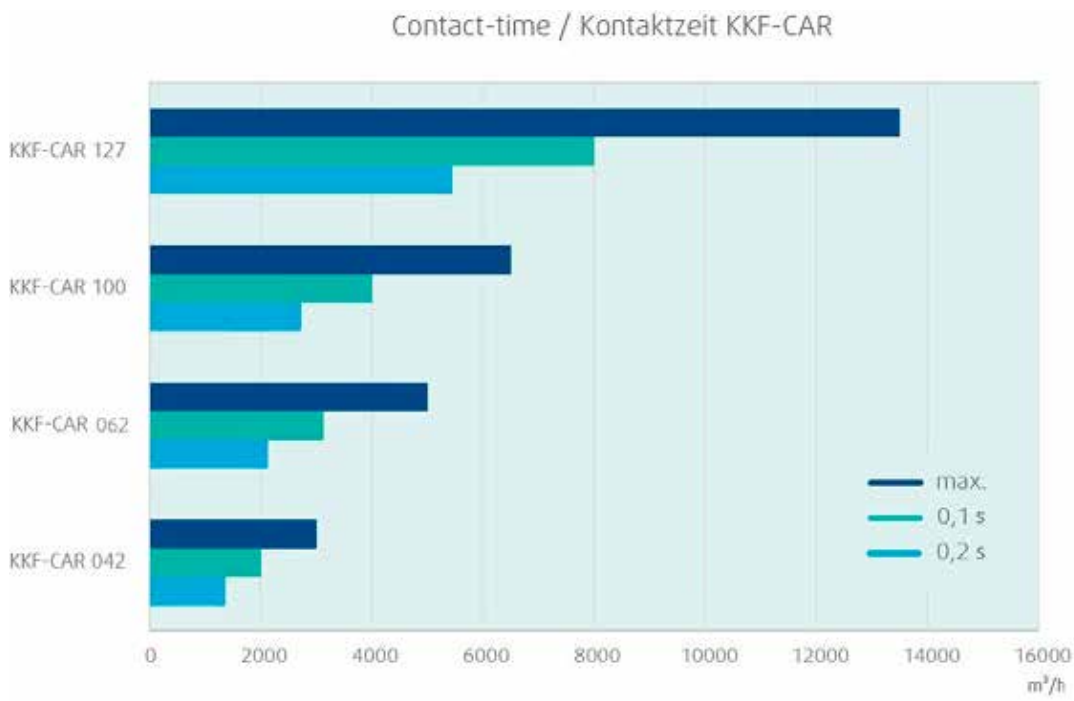
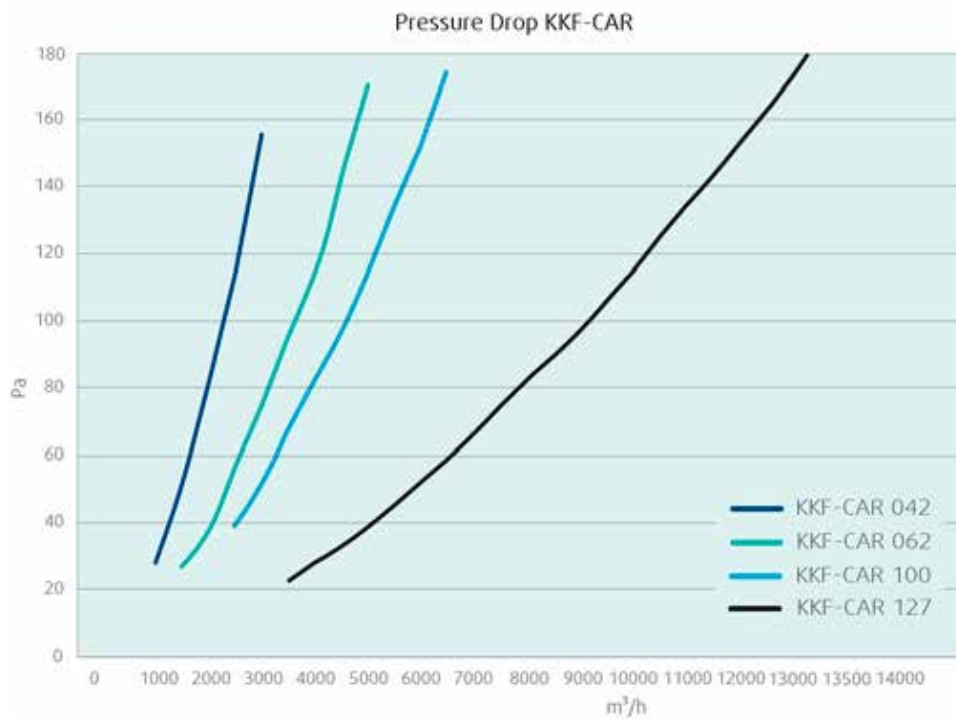
Performances



Get In Touch

 Call: [0845 6880112](tel:08456880112)
 Email: info@adremit.co.uk

Our Address

Puravent, Adremit Limited, Unit 5a, Commercial Yard,
Settle, North Yorkshire, BD24 9RH



KKF-KITCHEN – filter section



KKF-KITCHEN- Filter-section for MUB/T

The filter module is equipped with three filter-steps: an aluminium-mesh panelfilter with aluminium drip tray (without drain), a panelfilter ePM1 55 % (F7) and a carbon-cartridge-filter. The module is specially designed for kitchen-exhaust. The removable inspection-panel give you access for maintenance. The access-side can be changed on site.

The casing is a self-supporting construction of aluminium profile. Double skin panels made of galvanised sheet steel, with 30 mm sound and heat insulation made of mineral wool. Corners made of high shock-resistant plastic type PA6.

This fits exactly to our Multiboxes (MUB / MUB/T) in terms of dimensions and design, therefore it is directly connectable to the suitable Multibox. The necessary connecting material is already enclosed.

For maximum efficiency of the carbon-odor-filter, the contact time should be 0.2 seconds, until 0.1 seconds an odor-reduction can be achieved. See contact-time-diagram.

The filter-module can be operated temporarily at higher air volumes for maximum air exchange, according to the At this range with minimal odor-reduction.

Technical parameters

KKF-KITCHEN	Item no.
042	277363
062	277364
100	277367
127	277368

Dimensions

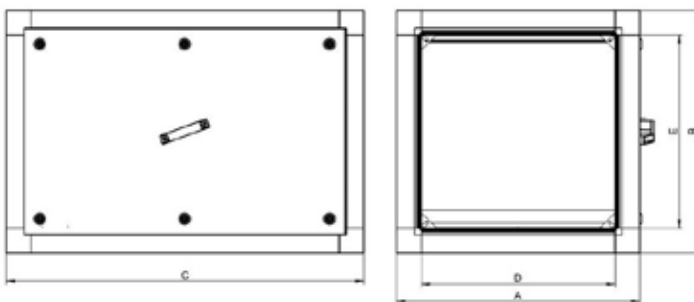

Type	Alu-filter		Panel-filter		Carbon-filter	
	W x H x T (mm)	Quantity	W x H x T (mm)	Quantity	D x L (mm)	Quantity
KKF-KITCHEN 042	625x545x48	1	625x545x94	1	145x450	16
KKF-KITCHEN 062	755x675x48	1	755x675x94	1	145x450	25
KKF-KITCHEN 100	875x314x48	3	875x477x94	2	145x450	32
KKF-KITCHEN 127	1145x404x50	3	1148x405x94	3	145x450	64

KKF	A	B	C	D	E
KKF-Kitchen 042	690 mm	690 mm	1020 mm	548 mm	548 mm
KKF-Kitchen 062	820 mm	820 mm	1020 mm	678 mm	678 mm
KKF-Kitchen 100	1020 mm	1020 mm	1210 mm	878 mm	878 mm
KKF-Kitchen 127	1290 mm	1290 mm	1210 mm	1148 mm	1148 mm

Get In Touch

Call: 0845 6880112
Email: info@adremit.co.uk

Our Address

Puravent, Adremit Limited, Unit 5a, Commercial Yard, Settle, North Yorkshire, BD24 9RH

Kennlinie Druckverlust

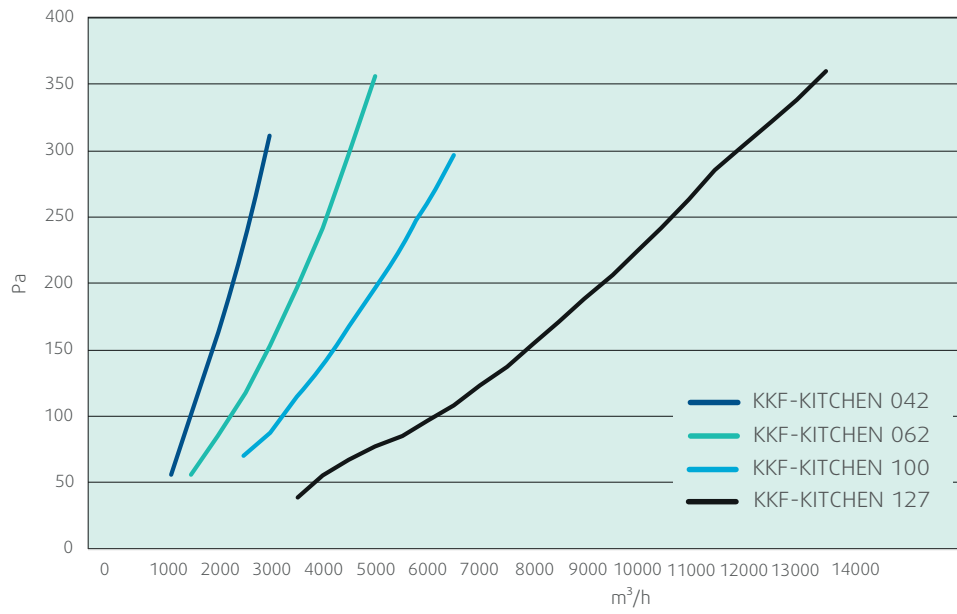

Contact-time / Kontaktzeit KKF-KITCHEN

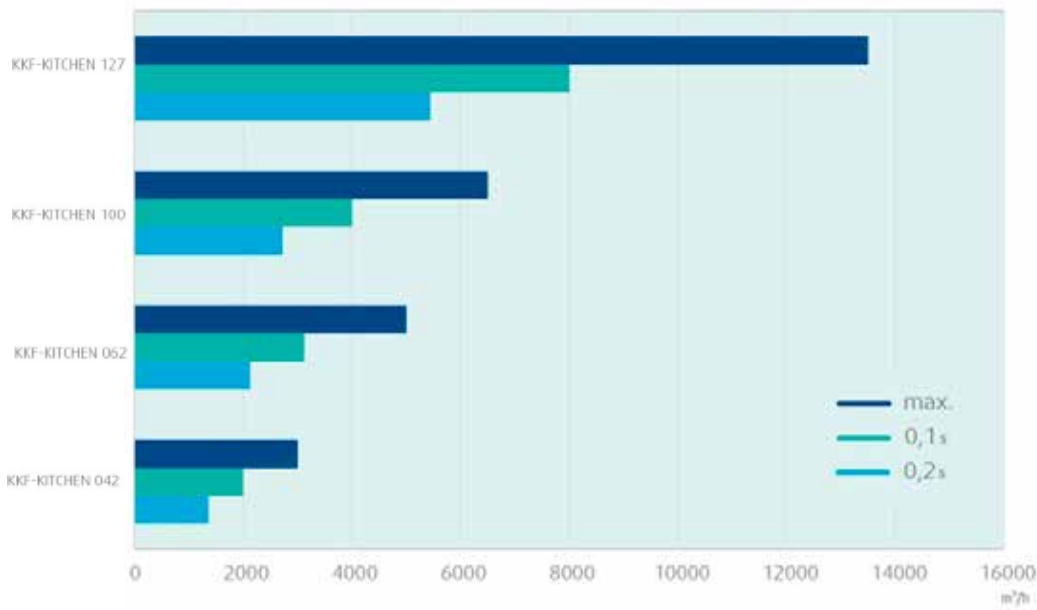

Get In Touch

Call: 0845 6880112
 Email: info@adremit.co.uk

Our Address

Puravent, Adremit Limited, Unit 5a, Commercial Yard,
 Settle, North Yorkshire, BD24 9RH

KKH-HW – heater section



KKH-HW – Water-heater-section for MUB

The heater-module is equipped with a 2-rows water-heating coil. The coil frame is made of galvanized steel, the tubes are made of copper and the fins are made of aluminum. The pipe-connections can be placed right or left in direction of airflow and have external threads, as well as drain and vent screws.

Technical parameters

KKH-HW	Item no.
025	93334
042	93339
062	93340
100	93341

Dimensions

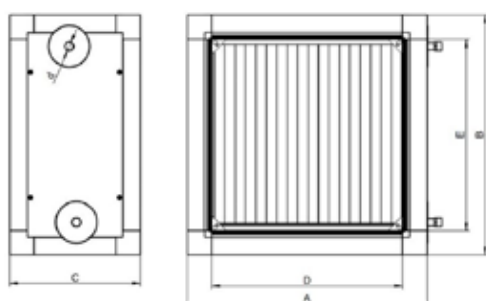

KKH-HW	A	B	C	D	E	d
KKH-HW-025	520 mm	520 mm	378 mm	378 mm	378 mm	1/2"
KKH-HW-042	690 mm	690 mm	378 mm	548 mm	548 mm	1/2"
KKH-HW-062	820 mm	820 mm	378 mm	678 mm	678 mm	1
KKH-HW-100	1020 mm	1020 mm	378 mm	878 mm	878 mm	1-1/2"

Performances

Type	Water-temp. (in/out)	air volume m ³ /h	Pressure drop air Pa	delta T T (°C)	Performance kW	Water-flow l/s	Pressure drop kPa
KKH-HW-025	70/50 °C	1.500	110	31	15	0,18	6,9
		1.000	55	37	12	0,15	4,6
	60/40 °C	1.500	110	25	12	0,15	4,7
		1.000	55	31	10	0,12	3,3
KKH-HW-042	70/50 °C	3.500	124	31	35	0,43	12,3
		2.500	70	37	30	0,37	10,0
	60/40 °C	3.500	124	27	30	0,36	10,1
		2.500	70	31	25	0,31	8,2
KKH-HW-062	70/50 °C	5.500	106	34	60	0,73	17,8
		4.000	61	37	48	0,59	13,8
	60/40 °C	5.500	106	27	48	0,58	14,1
		4.000	61	33	42	0,51	11,3
KKH-HW-100	70/50 °C	9.500	104	34	105	1,28	18,2
		6.500	55	39	83	1,01	15,7
	60/40 °C	9.500	104	29	89	1,08	15,3
		6.500	55	34	72	0,88	17,7

Get In Touch

Call: 0845 6880112
 Email: info@adremit.co.uk

Our Address

Puravent, Adremit Limited, Unit 5a, Commercial Yard, Settle, North Yorkshire, BD24 9RH

KKC-W-R and KKC-W-L – cooling section



KKC-W – Water-cooler-section for MUB

KKC-W-R: Connections in air direction on right side

KKC-W-L: Connections in air direction left side

The cooler-module is equipped with a 4-rows water-cooling coil. The coil frame is made of galvanized steel, the tubes are made of copper and the fins are made of aluminum. An aluminum drip-pan with drain-connection at side and a fix installed drop-eliminator are included. The pipe-connections have external threads, as well as drain and vent screws.

Technical parameters

KKC-W-R	Item no.	KKC-W-L	Item no.
025	277272	025	277268
042	277273	042	277269
062	277274	062	277270
100	277275	100	277271

Dimensions

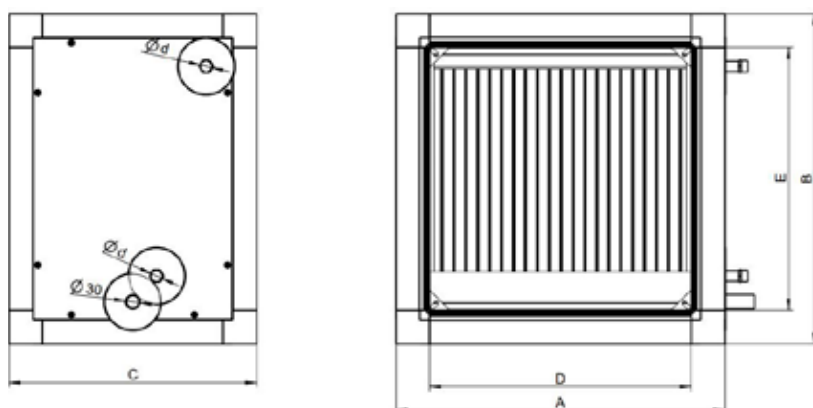

KKC-W-R	A	B	C	D	E	d
KKC-W-R 025	520 mm	520 mm	520 mm	378 mm	378 mm	1"
KKC-W-R 042	690 mm	690 mm	520 mm	548 mm	548 mm	1"
KKC-W-R 062	820 mm	820 mm	520 mm	678 mm	678 mm	1" 1/4
KKC-W-R 100	1020 mm	1020 mm	520 mm	878 mm	878 mm	1" 1/4

Performances

Type	Water-temp. (In/out)	Air volume m ³ /h	Pressure drop air Pa	Air-temp-in °C	Air-humidity-in %RH/rF	Air-temp-out °C	Performance kW	Water-flow l/s	Pressure drop kPa
KKC-W 025	6/12 °C	1.300	285	32	40	20	6	0,24	17,6
		800	137	32	40	18	5	0,18	10,8
KKC-W 042	6/12 °C	3.000	204	32	40	19	15	0,6	16,5
		2.000	112	32	40	17	13	0,5	32,1
KKC-W 062	6/12 °C	5.000	220	32	40	19	26	1,01	27,3
		3.500	131	32	40	18	21	0,81	36,5
KKC-W 100	6/12 °C	9.000	219	32	40	19	46	1,83	36,7
		6.500	138	32	40	18	38	1,49	28,1

Get In Touch

Call: 0845 6880112
Email: info@adremit.co.uk

Our Address

Puravent, Adremit Limited, Unit 5a, Commercial Yard, Settle, North Yorkshire, BD24 9RH

KKC-DX-R and KKC-DX-L – cooling section



KKC-DX – DX-cooler-section for MUB

KKC-DX-R: Connections in air direction on right side

KKC-DX-L: Connections in air direction on left side

The cooler-module is equipped with a 4-rows direct-expansion-cooling coil. The coil frame is made of galvanized steel, the tubes are made of copper and the fins are made of aluminum. An aluminum drip-pan with drain-connection at side and a fix installed drop-eliminator are included.

Technical parameters

KKC-DX-R	Item no.	KKC-DX-L	Item no.
025	277264	025	277260
042	277265	042	277261
062	277266	062	277262
100	277267	100	277263

Dimensions

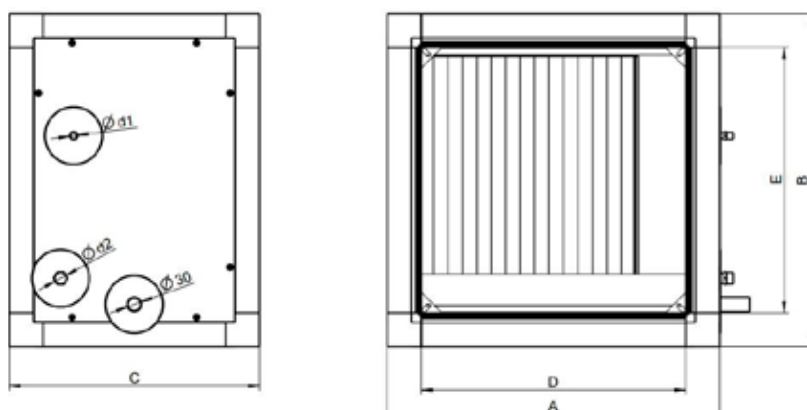

KKC-DX-R	A	B	C	D	E	d1	d2
KKC-DX-R 025	520 mm	520 mm	520 mm	378 mm	378 mm	12	22
KKC-DX-R 042	690 mm	690 mm	520 mm	548 mm	548 mm	12	22
KKC-DX-R 062	820 mm	820 mm	520 mm	678 mm	678 mm	22	28
KKC-DX-R 100	1020 mm	1020 mm	520 mm	878 mm	878 mm	28	35

Performances

Type	Refrigerant / Evapor. temp.	Air volume m ³ /h	Pressure drop air Pa	Air-temp-in °C	Air-humidity-in %RH/rF	Air-temp-out °C	Performance kW
KKC-DX 025	R410a / 6 °C	1.300	285	32	40	20	6
		800	133	32	40	18	5
KKC-DX 042	R410a / 6 °C	3.000	242	32	40	19	15
		2.000	147	32	40	17	13
KKC-DX 062	R410a / 6 °C	5.000	250	32	40	19	26
		3.500	143	32	40	18	21
KKC-DX 100	R410a / 6 °C	9.000	253	32	40	19	46
		6.500	152	32	40	18	38

Get In Touch

Call: 0845 6880112
Email: info@adremit.co.uk

Our Address

Puravent, Adremit Limited, Unit 5a, Commercial Yard, Settle, North Yorkshire, BD24 9RH

KKS silencer-section



KKS – Silencer-section for MUB

The silencer-module is equipped with splitters with a length of 750 mm.

Technical parameters

KKS	Item no.
025	276850
042	276851
062	276852
100	276853

Dimensions

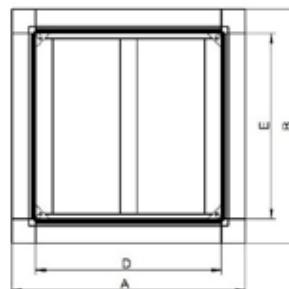
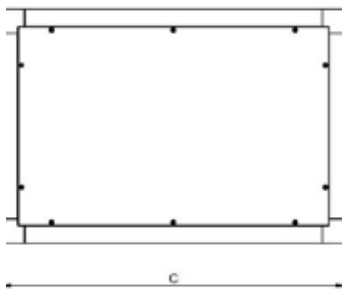

KKS	A	B	C	D	E
KKS 025	520 mm	520 mm	1020 mm	378 mm	378 mm
KKS 042	690 mm	690 mm	1020 mm	548 mm	548 mm
KKS 062	820 mm	820 mm	1020 mm	678 mm	678 mm
KKS 100	1020 mm	1020 mm	1020 mm	878 mm	878 mm

Characteristic pressure drop

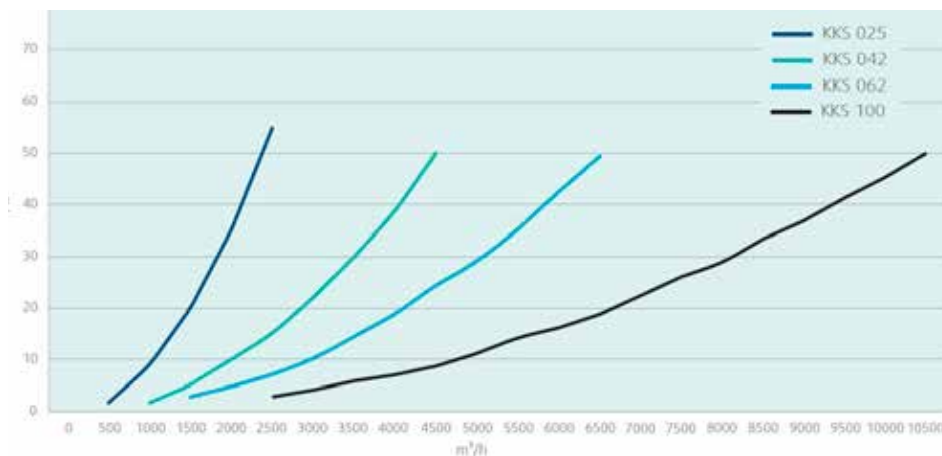

Get In Touch

Call: 0845 6880112
 Email: info@adremit.co.uk

Our Address

Puravent, Adremit Limited, Unit 5a, Commercial Yard,
 Settle, North Yorkshire, BD24 9RH

GRU-MUB



GRU – Base frame for MUB

The base frame is specially designed to support the Multibox (MUB) fan modules and has a height of 100 mm. Width and length are adapted to the respective Multibox sizes.

The base frame profiles are made of galvanised steel sheet. The screws and nuts required for mounting are included in the scope of delivery.

Supplied as a kit..

Technical parameters

GRU	Item no.
025	276660
042	276661
062	276662
100	276663
127	276664

Dimensions

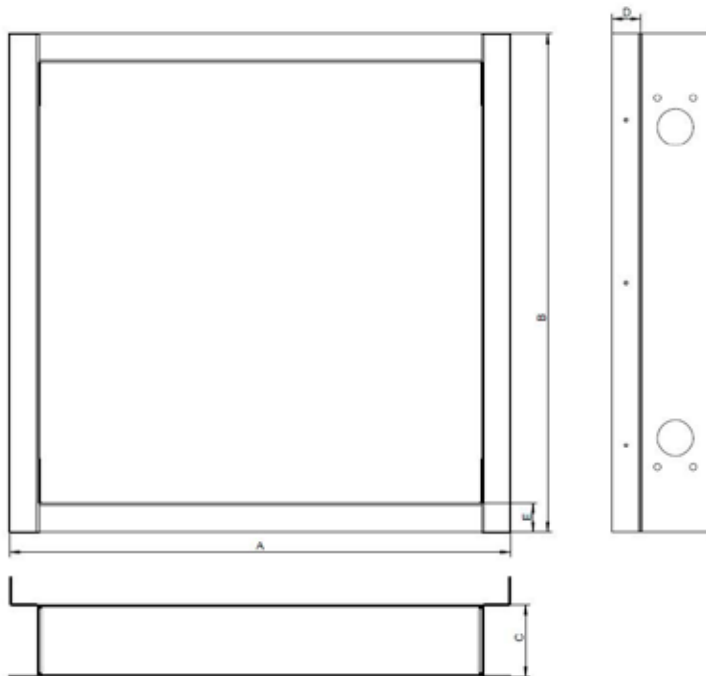

GRU	A	B	C	D	E
025	525 mm	520 mm	100 mm	40 mm	40 mm
042	695 mm	690 mm	100 mm	40 mm	40 mm
062	825 mm	820 mm	100 mm	40 mm	40 mm
100	1025 mm	1020 mm	100 mm	40 mm	40 mm
127	1295 mm	1290 mm	100 mm	40 mm	40 mm

Get In Touch

Call: [0845 6880112](tel:08456880112)
 Email: info@adremit.co.uk

Our Address

Puravent, Adremit Limited, Unit 5a, Commercial Yard,
 Settle, North Yorkshire, BD24 9RH

GRU MUB+Filter base frame



GRU – Base frame for MUB+FILTER

The base frame is specially designed to support the MUB+FILTER fan-filtermodules and has a height of 100 mm. Width and length are adapted to the respective MUB+FILTER sizes.

The base frame profiles are made of galvanised steel sheet. The screws and nuts required for mounting are included in the scope of delivery.

Supplied as a kit.

Technical parameters

GRU for MUB+FILTER	Item no.
025	278451
042	278452
062	278453

Dimensions

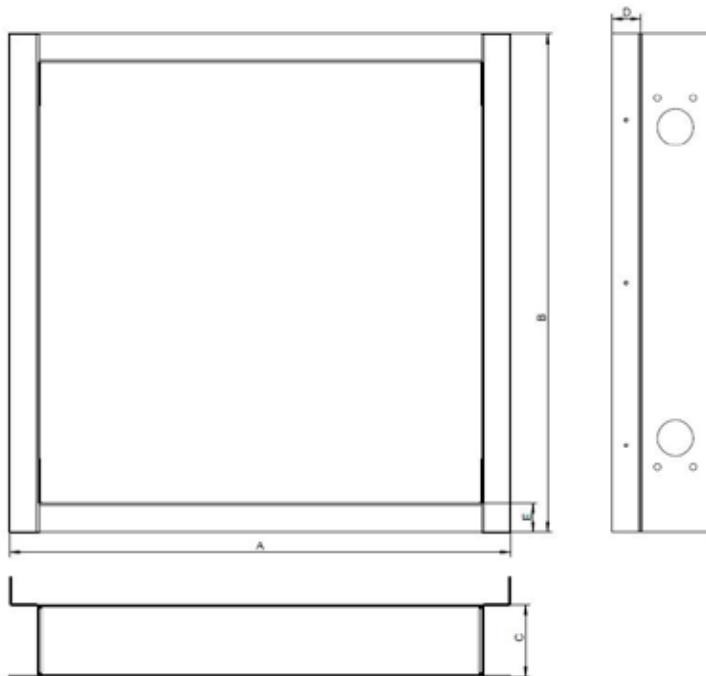

GRU + FILTER	A	B	C	D	E
025	525 mm	690 mm	100 mm	40 mm	40 mm
042	695 mm	820 mm	100 mm	40 mm	40 mm
062	825 mm	1020 mm	100 mm	40 mm	40 mm

Get In Touch

Call: 0845 6880112
 Email: info@adremit.co.uk

Our Address

Puravent, Adremit Limited, Unit 5a, Commercial Yard,
 Settle, North Yorkshire, BD24 9RH

WSD MUB+KKF



WSD MUB+KKF

Weather protection for combination of Multibox MUB and filter-section KKF

Made of seawater resistant aluminum. Edges are welded. Inclusive mounting accessories!

We recommend to order the WSD factory mounted or prepared, because special tools are needed!

For all other combination suitable weather roofs can be offered on request.

Technical parameters

WSD MUB + KKF	Item no.
025	238061
042	238062
062	238063
100	238064

Dimensions

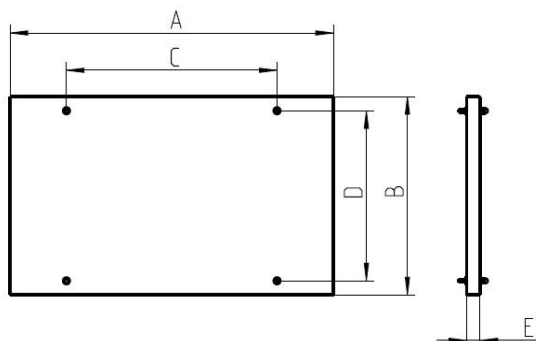

WSD MUB + KKF	A	B	C	D	E
025/30	958 mm	580 mm	618 mm	480 mm	38 mm
042/30	1128 mm	760 mm	788 mm	660 mm	38 mm
062/30	1258 mm	880 mm	918 mm	780 mm	38 mm
100/30	1600 mm	1080 mm	1260 mm	980 mm	38 mm

Get In Touch

Call: [0845 6880112](tel:08456880112)
 Email: info@adremit.co.uk

Our Address

Puravent, Adremit Limited, Unit 5a, Commercial Yard,
 Settle, North Yorkshire, BD24 9RH

WSD MUB+FILTER



Weather protection for MUB+FILTER (MUB with integrated filter)

Made of seawater resistant aluminum. Edges are welded. Inclusive mounting accessories!

We recommend to order the WSD factory mounted or prepared, because special tools are needed!

Technical parameters

WSD MUB + Filter	Item no.
025	278543
042	278544
062	278545

Dimensions

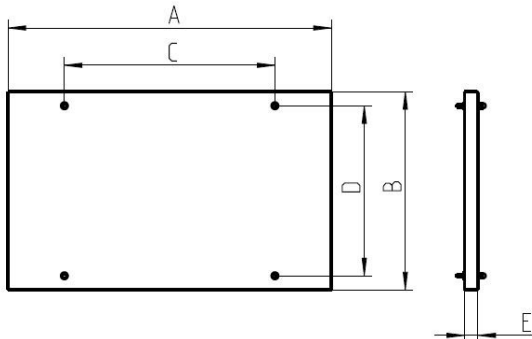

WSD MUB + Filter	A	B	C	D	E
02	750 mm	580 mm	430 mm	480 mm	38 mm
042	880 mm	750 mm	560 mm	650 mm	38 mm
062	1080 mm	880 mm	760 mm	780 mm	38 mm

Get In Touch

Call: 0845 6880112
 Email: info@adremit.co.uk

Our Address

Puravent, Adremit Limited, Unit 5a, Commercial Yard,
 Settle, North Yorkshire, BD24 9RH

WSD MUB-HEPA

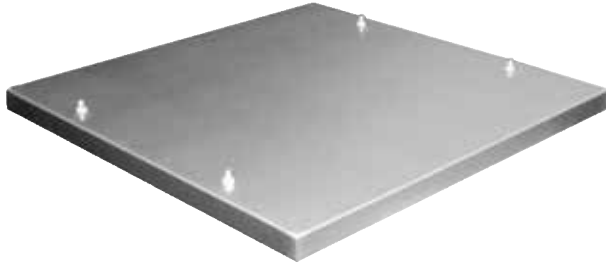

WSD 042 MUB-HEPA

Weather protection for Multiboxes, type MUB-HEPA.

Made of seawater resistant aluminum. Edges are welded. Inclusive mounting accessories!

We recommend to order the WSD factory mounted or prepared, because special tools are needed!

Technical parameters

WSD MUB-HEPA	Item no.
042	238060

Dimensions

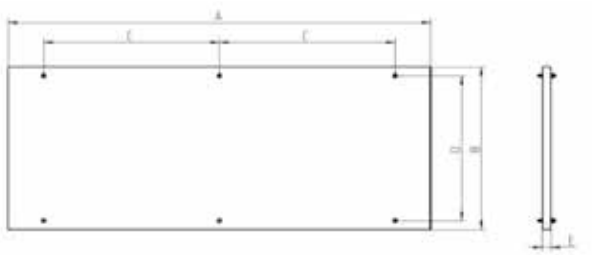

WSD MUB-HEPA	A	B	C	D	E
042/30	1960 mm	750 mm	810 mm	650 mm	38 mm

Get In Touch

 Call: [0845 6880112](tel:08456880112)
 Email: info@adremit.co.uk

Our Address



Puravent, Adremit Limited, Unit 5a, Commercial Yard,
Settle, North Yorkshire, BD24 9RH



Systemair GmbH
Seehöfer Straße 45
D-97944 Boxberg

Tel.: +49 7930 9272-0
Fax: +49 7930 9272-92
info@systemair.de
www.systemair.de

Get In Touch

 **Call:** [0845 6880112](tel:08456880112)
 **Email:** info@adremit.co.uk

Our Address

Puravent, Adremit Limited, Unit 5a, Commercial Yard,
Settle, North Yorkshire, BD24 9RH

