

ROOFTOP



Move the boiler room outside the building

The Mark ROOFTOP provides the option of moving the boiler room outside the building for optimal use of the floor area released as a result. The ROOFTOP is manufactured as standard with a seawater-resistant outer coating. The ROOFTOP can be fitted with a single or several gas-fired air heaters for a capacity range from 20 to 384 kW coupled with large air volumes. Options with this versatile product include air filtering, recirculation and/or fresh outside air, duct connection or use of an outlet plenum.

The ROOFTOP is particularly suitable for roof mounting in, for example: distribution centres, workshops, sports halls and offices.

Features of the Mark ROOFTOP

- Seawater-resistant aluminium housing ALMg3
- Low weight
- Wide application
- Galvanized lower frame.

mark[®]

Get In Touch

 Call: 0845 6880112
 Email: info@adremit.co.uk

Our Address

Puravent, Adremit Limited, Unit 5a, Commercial Yard,
Settle, North Yorkshire, BD24 9RH

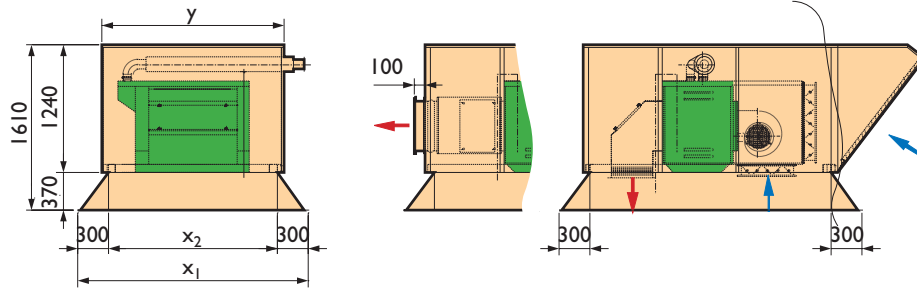

Options

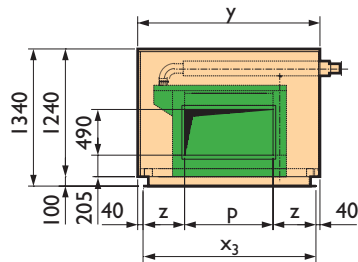

MONO RT

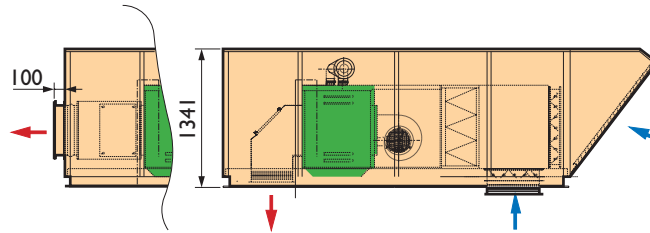

TWIN RT

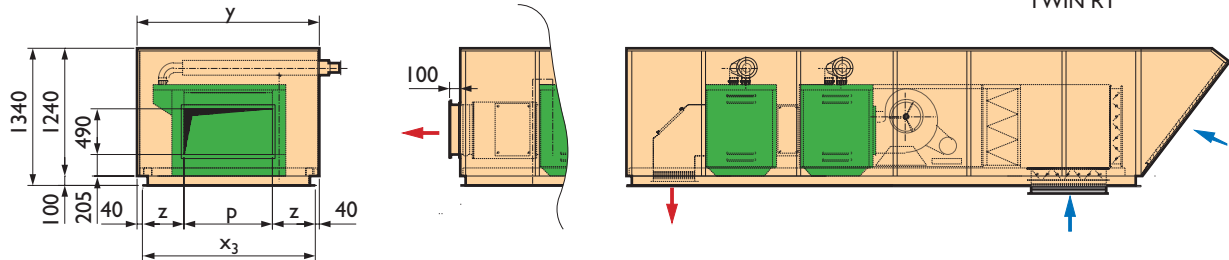

| Type | p | x1 | x2 | x3 | y | z |
|-----------|------|------|------|------|------|-------|
| 18/21 | 405 | 1650 | 1050 | 1090 | 1170 | 342,5 |
| 24/28 | 405 | 1650 | 1050 | 1090 | 1170 | 432,5 |
| 33/37 | 470 | 1650 | 1050 | 1090 | 1170 | 310 |
| 44/49 | 600 | 1850 | 1250 | 1290 | 1370 | 345 |
| 55/59 | 730 | 1850 | 1250 | 1290 | 1370 | 280 |
| 66/74 | 860 | 2250 | 1650 | 1690 | 1770 | 415 |
| 88/98/104 | 1120 | 2250 | 1650 | 1690 | 1770 | 285 |



Get In Touch

Call: [0845 6880112](tel:08456880112)
 Email: info@adremit.co.uk

Our Address

Puravent, Adremit Limited, Unit 5a, Commercial Yard,
 Settle, North Yorkshire, BD24 9RH

MONO

| Type | | 18 | 21 | 24 | 28 | 33 | 37 | 44 | 49 | 55 | 59 | 66 | 74 | 88 | 98 | 104* | 104 |
|----------------------------|------|-------|-------|-------|-------|-------|-------|-------|-------|---------|---------|---------|---------|---------|---------|---------|---------|
| Nominal power | kW | 20,4 | 21,8 | 25,1 | 27,2 | 30,2 | 32,7 | 40,2 | 43,6 | 50,2 | 54,5 | 60,3 | 65,3 | 80,4 | 87,1 | 91,8 | 95,8 |
| Nominal load (lower value) | kW | 22,7 | 24,2 | 27,9 | 30,2 | 33,5 | 36,3 | 44,7 | 48,4 | 55,8 | 60,5 | 67,0 | 72,6 | 89,3 | 96,8 | 102,0 | 106,5 |
| Air displacement (15°C) | m³/h | 2190 | 2410 | 2730 | 3005 | 3320 | 3650 | 4425 | 4865 | 5525 | 6080 | 6635 | 7295 | 8845 | 9730 | 10250 | 10250 |
| Gas consumption G25 (15°C) | m³/h | 2,7 | 3,0 | 3,3 | 3,6 | 4,0 | 4,4 | 5,4 | 5,9 | 6,6 | 7,1 | 8,0 | 8,7 | 10,6 | 11,6 | 12,5 | 12,8 |
| Gas consumption G20 (15°C) | m³/h | 2,4 | 2,6 | 2,9 | 3,1 | 3,5 | 3,8 | 4,7 | 5,1 | 5,8 | 6,3 | 7,0 | 7,6 | 9,3 | 10,1 | 10,5 | 11,1 |
| Gas consumption G31 (15°C) | kg/h | 1.76 | -- | 2.17 | -- | 2.60 | -- | 3.47 | -- | 4.33 | -- | 5.21 | -- | 6.94 | -- | -- | -- |
| Gas consumption G30 (15°C) | kg/h | 1.79 | -- | 2.20 | -- | 2.64 | -- | 3.53 | -- | 4.40 | -- | 5.28 | -- | 7.04 | -- | -- | -- |
| Delta T (ΔT) | K | 29 | 28 | 29 | 28 | 29 | 28 | 29 | 28 | 29 | 28 | 29 | 28 | 29 | 28 | 27 | 28 |
| Supply voltage (50Hz) | V | 1~230 | 1~230 | 1~230 | 1~230 | 1~230 | 1~230 | 1~230 | 1~230 | 3~400+N | 3~400+N | 3~400+N | 3~400+N | 3~400+N | 3~400+N | 3~400+N | 3~400+N |

* = Low NOx

Delta T max. 45K

External pressure 0-300 Pa, more on request

G25 = Natural gas / G20 = Natural gas / G31 = Propane / G30 = Butane

TWIN

| Type | | 66 | 74 | 88 | 98 | 104* | 104 |
|----------------------------|------|---------|---------|---------|---------|---------|---------|
| Nominal power | kW | 120,6 | 130,6 | 160,8 | 174,2 | 183,6 | 191,6 |
| Nominal load (lower value) | kW | 134,0 | 145,2 | 178,6 | 193,6 | 204,0 | 213,0 |
| Air displacement (15°C) | m³/h | 12000 | 12000 | 15000 | 15000 | 15000 | 15000 |
| Gas consumption G25 (15°C) | m³/h | 16,0 | 17,4 | 21,2 | 23,2 | 25,0 | 25,6 |
| Gas consumption G20 (15°C) | m³/h | 14,0 | 15,2 | 18,6 | 20,2 | 21,0 | 22,2 |
| Gas consumption G31 (15°C) | kg/h | 10,4 | -- | 13,9 | -- | -- | -- |
| Gas consumption G30 (15°C) | kg/h | 10,6 | -- | 14,1 | -- | -- | -- |
| Delta T (ΔT) | K | 32 | 34 | 34 | 36 | 38 | 40 |
| Supply voltage (50Hz) | V | 3~400+N | 3~400+N | 3~400+N | 3~400+N | 3~400+N | 3~400+N |

* = Low NOx

Delta T max. 45K

External pressure 0-300 Pa, more on request

G25 = Natural gas / G20 = Natural gas / G31 = Propane / G30 = Butane

Assembly/location suggestions

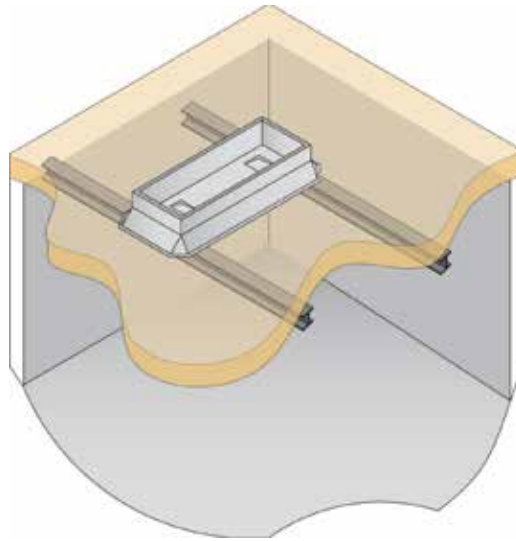

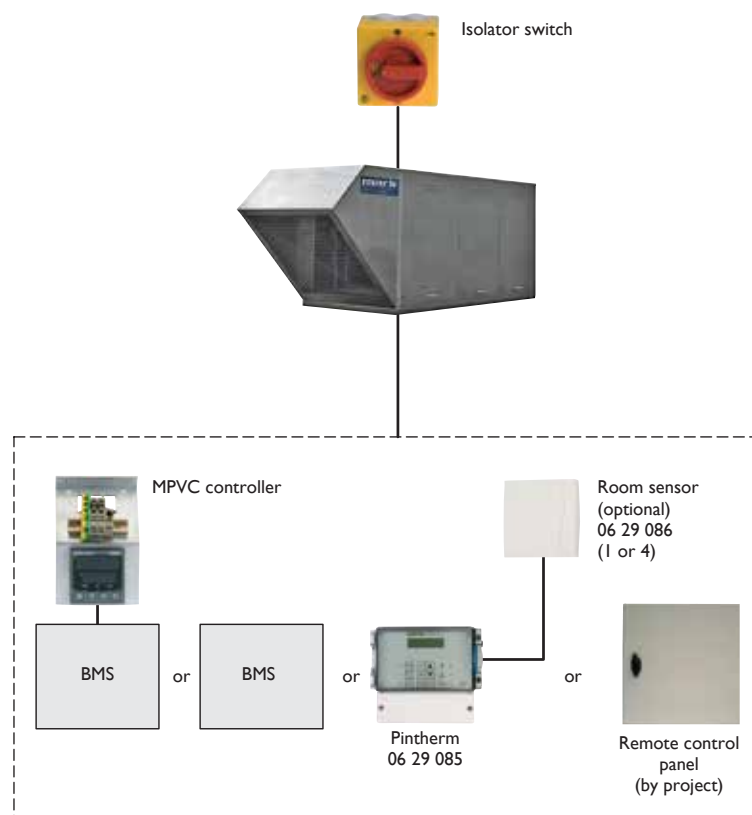

Example of roof pass-through

Controls



Get In Touch

 Call: [0845 6880112](tel:08456880112)
 Email: info@adremit.co.uk

Our Address

Puravent, Adremit Limited, Unit 5a, Commercial Yard,
Settle, North Yorkshire, BD24 9RH