



Keep cold and contaminated air outside

Due to its broad range, the EASYAIR water-supplied or electric air curtain can be used in any sort of open entrance, such as in shops, supermarkets, builder's merchants, offices and hospitals. The air curtain is suitable for an installation height of up to 3.50 metres and is available in widths from 1.0 to 3.0 metres.

The use of a three-row heat exchanger means that the EASYAIR air curtain is energy efficient. The water-supplied air curtain is supplied as standard for a low water temperature of 60/40°C. The conversion table may be used for other water temperatures.

By using a thermostatic 3-way valve, the air outlet temperature of the air curtain can be kept constant.

Suitable for use in shops, offices, hospitals and factories.

Features:

- Extensive range
- Standard white finish
- Simple installation
- Easy to maintain

mark[®]

Get In Touch



Call: [0845 6880112](tel:08456880112)



Email: info@adremit.co.uk

Our Address

Puravent, Adremit Limited, Unit 5a, Commercial Yard, Settle, North Yorkshire, BD24 9RH



Dimensions

TYPE S/M/L

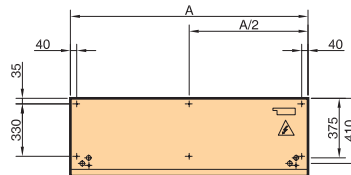
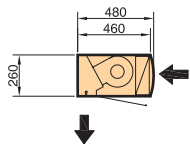

- Lengths A (mm)
- 1.000
 - 1.500
 - 2.000
 - 2.500

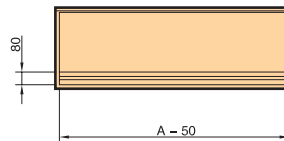
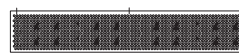

TYPE GX/GXX

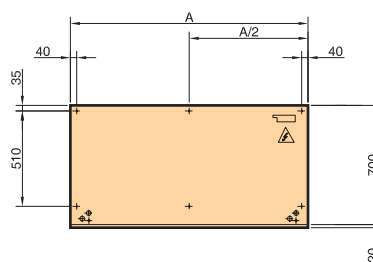
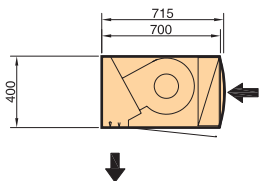

- Lengths A (mm)
- 1.000
 - 1.500
 - 2.000
 - 2.500

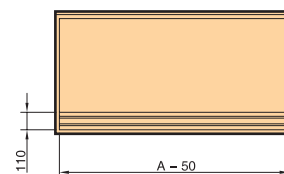
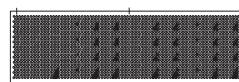

Technical information

Conversion table

Ta Water °C	Ta Air + 15°C	Ta Air + 18°C	Ta Air + 20°C
100/80	2,77	2,65	2,56
90/70	2,38	2,25	2,17
80/60	1,98	1,86	1,78
70/50	1,58	1,46	1,38
60/40	1,20	1,08	1,00
55/35	1,00	0,89	0,80

Get In Touch

Call: 0845 6880112
 Email: info@adremit.co.uk

Our Address

Puravent, Adremit Limited, Unit 5a, Commercial Yard,
 Settle, North Yorkshire, BD24 9RH



Type	Length	Air displacement	Heating capacity of water 60/40 °C	Water-side resistance water 60/40 °C	Water connection	Connection voltage of heating element	Electrical heating capacity	Connection voltage of fans	Nominal power	Current fan	Sound pressure	Weight
	mm	m ³ /h	kW	kPa	Inside wire	V (50 Hz)	kW	V (50 Hz)	kW	A	dB(A)*	kg
Easyair S recommended mounting height (lower side of air curtain) max. 2,10 m												
S 1000 P	1000	1200	6,50	2,50	2 x 3/4"	–	–	I ~ 230	0,370	1,66	40/53	45
S 1500 P	1500	1800	10,00	10,70	2 x 3/4"	–	–	I ~ 230	0,555	2,49	40/54	76
S 2000 P	2000	2400	14,10	4,30	2 x 3/4"	–	–	I ~ 230	0,740	3,32	40/55	106
S 2500 P	2500	3000	18,70	7,30	2 x 3/4"	–	–	I ~ 230	0,925	4,15	40/56	135
S 1000 E	1000	1200	–	–	–	3 ~ 400	3/6/9	I ~ 230	0,370	1,66	40/53	45
S 1500 E	1500	1800	–	–	–	3 ~ 400	4/8/12	I ~ 230	0,555	2,49	40/54	76
S 2000 E	2000	2400	–	–	–	3 ~ 400	6/12/18	I ~ 230	0,740	3,32	40/55	106
S 2500 E	2500	3000	–	–	–	3 ~ 400	6/12/18	I ~ 230	0,925	4,15	40/56	135
Easyair M recommended mounting height (lower side of air curtain) max. 2,4 m												
M 1000 P	1000	1800	9,70	6,30	2 x 3/4"	–	–	I ~ 230	0,555	2,49	40/54	47
M 1500 P	1500	2700	13,30	7,90	2 x 3/4"	–	–	I ~ 230	0,740	3,32	40/55	78
M 2000 P	2000	3600	20,80	7,80	2 x 3/4"	–	–	I ~ 230	0,925	4,15	40/56	108
M 2500 P	2500	4500	24,10	5,80	2 x 3/4"	–	–	I ~ 230	1,110	4,98	40/57	140
M 1000 E	1000	1850	–	–	–	3 ~ 400	3/6/9	I ~ 230	0,555	2,49	40/54	47
M 1500 E	1500	2775	–	–	–	3 ~ 400	4/8/12	I ~ 230	0,740	3,32	40/55	78
M 2000 E	2000	3700	–	–	–	3 ~ 400	6/12/18	I ~ 230	0,925	4,15	40/56	108
M 2500 E	2500	4625	–	–	–	3 ~ 400	6/12/18	I ~ 230	1,110	4,98	40/57	140
Easyair L recommended mounting height (lower side of air curtain) max. 2,7 m												
L 1000 P	1000	2700	10,80	7,80	2 x 3/4"	–	–	I ~ 230	0,821	3,57	40/55	50
L 1500 P	1500	3600	18,10	14,40	2 x 3/4"	–	–	I ~ 230	1,095	4,76	40/56	80
L 2000 P	2000	5400	26,10	12,20	2 x 3/4"	–	–	I ~ 230	1,642	7,14	40/57	110
L 2500 P	2500	6300	32,60	10,30	2 x 3/4"	–	–	I ~ 230	1,916	8,33	40/58	142
L 1000 E	1000	2775	–	–	–	3 ~ 400	5/10/15	I ~ 230	0,821	3,57	40/55	50
L 1500 E	1500	3700	–	–	–	3 ~ 400	7,5/15/22,5	I ~ 230	1,095	4,76	40/56	80
L 2000 E	2000	5550	–	–	–	3 ~ 400	10/20/30	I ~ 230	1,642	7,14	40/57	110
L 2500 E	2500	6475	–	–	–	3 ~ 400	10,7/21,4/32	I ~ 230	1,916	8,33	40/58	142
Easyair GX recommended mounting height (lower side of air curtain) max. 3 m												
Easyair GXX recommended mounting height (lower side of air curtain) max. 3,6 m												
GX 1000 P	1000	4000	16,60	1,55	2 x 1"	–	–	I ~ 230	0,880	4,60	40/55	95
GX 1500 P	1500	6000	27,10	3,03	2 x 1"	–	–	I ~ 230	1,320	6,90	40/57	125
GX 2000 P	2000	8000	37,10	3,41	2 x 1 1/4"	–	–	I ~ 230	1,760	9,20	40/58	155
GX 2500 P	2500	10000	47,30	4,40	2 x 1 1/4"	–	–	I ~ 230	2,200	10,20	40/60	200
GXX 1000 P	1000	5000	19,70	1,97	2 x 1"	–	–	I ~ 230	1,140	9,90	40/57	110
GXX 1500 P	1500	7500	31,40	3,69	2 x 1"	–	–	I ~ 230	1,710	13,35	40/58	145
GXX 2000 P	2000	10000	42,60	3,38	2 x 1 1/4"	–	–	I ~ 230	2,280	17,80	40/61	180
GXX 2500 P	2500	12500	54,80	5,85	2 x 1 1/4"	–	–	I ~ 230	2,850	23,00	40/62	225

* Measured at 3m.

Get In Touch

Call: 0845 6880112
Email: info@adremit.co.uk

Our Address

Puravent, Adremit Limited, Unit 5a, Commercial Yard, Settle, North Yorkshire, BD24 9RH

Accessories – additional sections

Type GTM I
 5-position controller for hot water air curtain.
 Do not switch more than 10 air curtains in parallel on one GTM I controller.



Dimensions 122 x 70 x 35 mm

Type GTM IE
 5-position controller for electrically heated air curtains.
 Standard controller. The parallel connection of multiple air curtains on one controller is not possible!



Dimensions 122 x 70 x 35mm



Connecting cable between controller and air curtain



Thermostatic three-way valve



Room thermostat



Door contact



Ceiling fixing set

Assembly/location suggestions

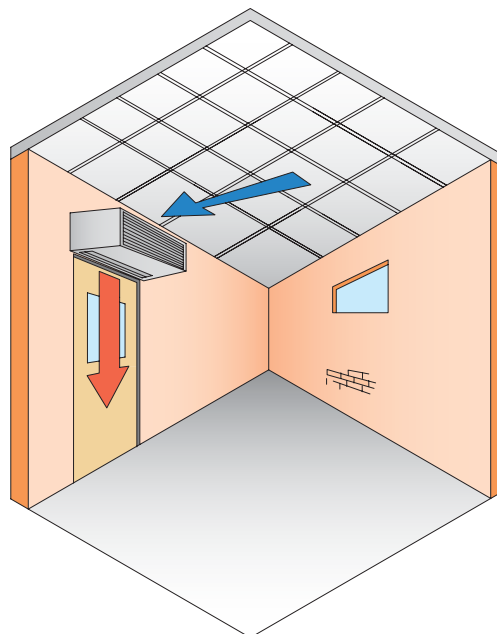

Get In Touch

Call: [0845 6880112](tel:08456880112)
 Email: info@adremit.co.uk

Our Address

Puravent, Adremit Limited, Unit 5a, Commercial Yard,
 Settle, North Yorkshire, BD24 9RH

Controls

EASYAIR P (hot water air curtain)

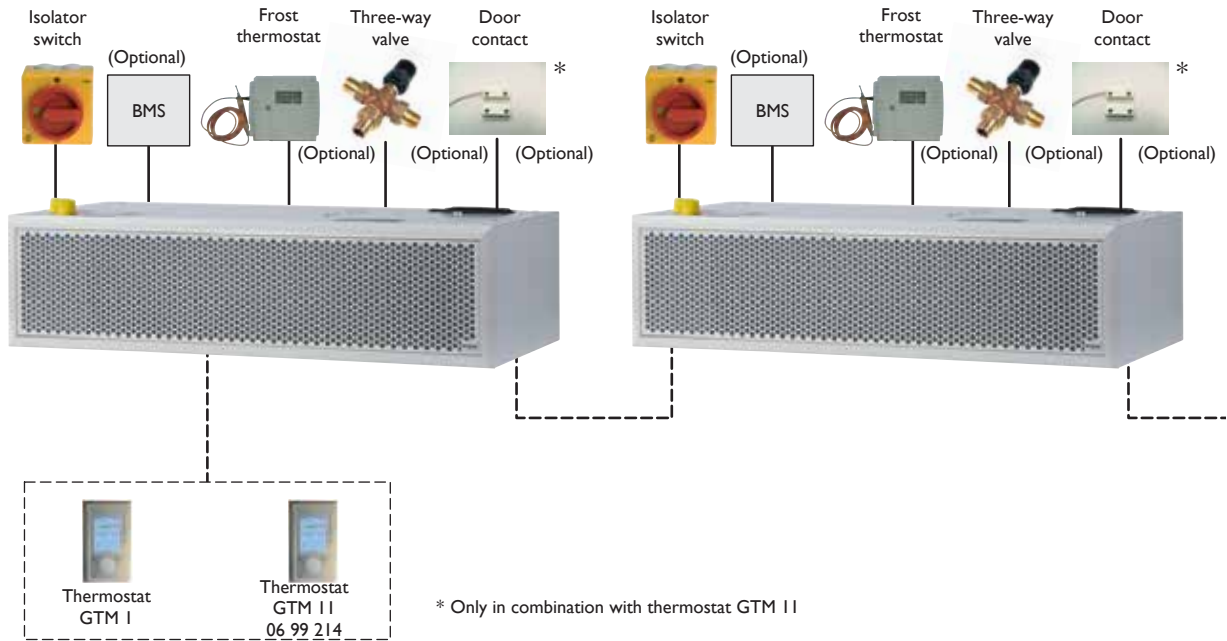

EASYAIR E (electrically heated air curtain)

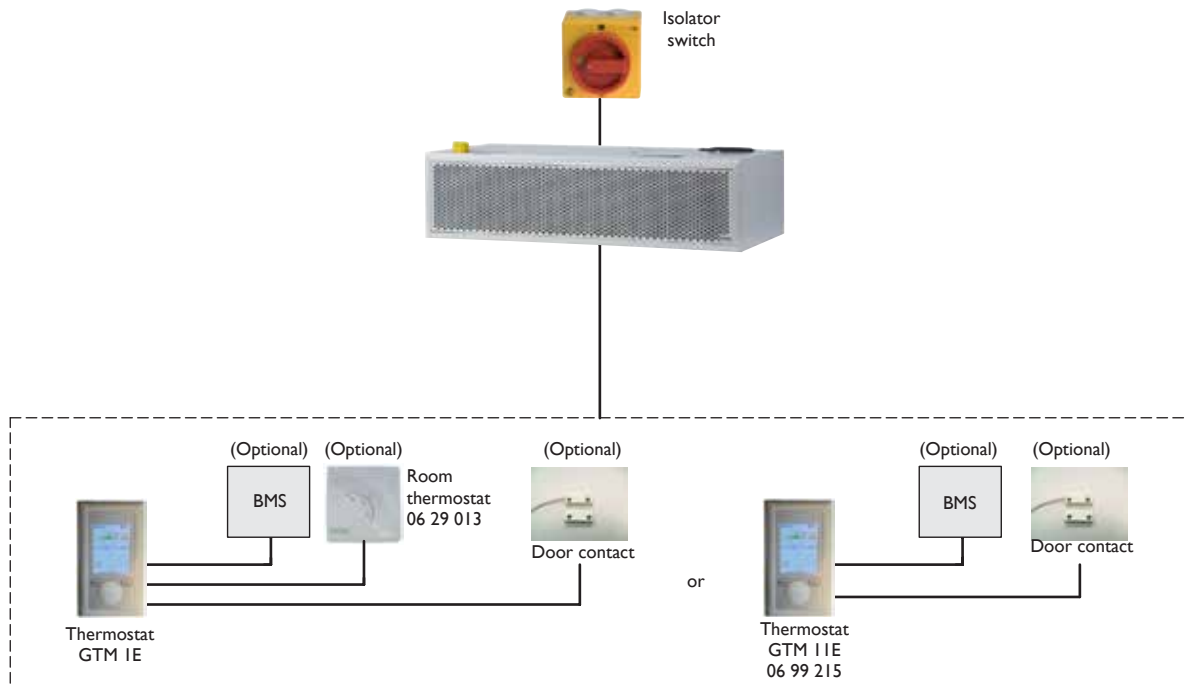

Get In Touch

Call: [0845 6880112](tel:08456880112)
 Email: info@adremit.co.uk

Our Address

Puravent, Adremit Limited, Unit 5a, Commercial Yard,
 Settle, North Yorkshire, BD24 9RH